

Adani Mining Pty Ltd Carmichael Coal Project

Carmichael East
Mining Lease Application

™

LIST OF CONTENTS

1 Mining Lease application

2 Attachments to Mining Lease Application

2.1 Attachment-A: Survey plan

2.2 Attachment-B: External Boundary Area Description

2.3 Back ground Land Tenure Details

2.4 Company Registration Certificate

2.5 Exploration Permit

2.6 Company Financial Position

2.7 Infrastructure and Employment

2.8 Initial Development Plan (Revised)

2.9 Coal Seam Gas- Statement and Assessment Criteria

3 Additional Information to Mining Lease Application

3.1 Restricted Land consents from land holder (further correspondence)

3.2 Survey report

3.3 Consent Letter from Waratah

3.4 Amendment to Surface Area

3.5 Consent letter from ATP holder for Petroleum and Gas

Mining Lease Application

Ref. No: Carmichael North and East
Contact:
Telephone:
Facsimile:
Email:



**Queensland
Government**

28 November 2012

Adani Mining Pty Ltd
C/- Mining Tenement Services
GPO Box 215
BRISBANE QLD 4001

Dear Mr Thompson,

RE: MINING LEASE APPLICATIONS

I acknowledge that documents pertaining to the Carmichael North and Carmichael East Mining Lease applications were lodged in the Emerald District Office today.

Yours sincerely

A handwritten signature in black ink, appearing to be 'S. Brown', written over a horizontal line.

Shawn Brown
Mining Registrar
Emerald District

Department of
Natural Resources and Mines
PO Box 3679
RED HILL QLD 4701
Queensland 4700 Australia
Telephone + 61 7 49360362
Facsimile + 61 7 49360375
Website www.deedi.qld.gov.au
ABN 98 628 485 885



Receipt / Tax Invoice
Queensland Mines and Energy
Department of Natural Resources and Mines
 (ABN: 59 020 847 551)

28 Nov 2012 02:57 pm

Page 1 of 1

GRR_200 3.0.9

Receipt Number : EM307198 **Date Payment Received :** 28-NOV-2012

Received From : ADANI MINING PTY LTD
Address : C/- MINING TENEMENT SERVICES
 GPO BOX 215
 BRISBANE
 QLD
 4001

Payment Details

Pay Method: Cheque / Aust. Money Order
Cheque No. : 200502
Bank : NAB
Branch : Capital Office 308-322 Queen Brisbane QLD 4000

Remarks :

APPLICATION FEE ML- CARMICHAEL NORTH- \$3731.00
 PART APPLICATION FOR AMENDMENT FEÉ EA \$133.70

Description	QTY	Price	GST*	Total Amount
AMEND APPL ENV AUTH MINING	1	\$133.70	\$0.00	\$133.70
APPLICATION FEE MINING LEASE COAL	1	\$3,731.00	\$0.00	\$3,731.00
Totals:		\$3,864.70	\$0.00	\$3,864.70

Amount Received:	\$3,864.70
-------------------------	-------------------

Cashier : Kevin POKARIER
Per Authorised Accounting Officer 

Cheques or other negotiable instruments accepted subject to clearance.

Contact: Emerald District Office - (07) 4987 9373

Business use only

Total Administered: \$3,864.70
 Total Receipt: \$3,864.70

* GST is a Commonwealth Government Tax; # Refund has been authorised but has not been approved

EAST



Queensland Government

ML No.

(Office Use Only)

Department of Employment, Economic Development and Innovation
Mines

www.deedi.qld.gov.au ABN 24 830 236 406

APPLICATION FOR MINING LEASE

Section 245

Mineral Resources Act 1989

Form Number MRA-15 Version Number 7

OFFICIAL USE ONLY	
ML No.	
PART A	
Received AT	Received BY
DATE	TIME
/ /	: AM PM
PART B	
Document accepted as an application for a Mining Lease in accordance with section 81 of the <i>Mineral Resources Regulation 2003</i> .	
Mining Registrar	
(SIGNATURE)	
DATE / /	
FEE Paid	RECEIPT no.
PART C	
ENTERED on register by	
(SIGNATURE)	
DATE / /	

The completed original plus two copies of this application and any attachments must be submitted with the prescribed fee at the Office of the Mining Registrar for the mining district in which the land is situated.

The document submitted must first be accepted by the Mining Registrar as an application for a mining lease under the provisions of section 81 of the Mineral Resources Regulation 2003 before registration.

Note: A document containing information that is false or misleading may attract a maximum penalty of 200 penalty units.

If form is to be completed by hand please print clearly in ink and use block letters.

1. APPLICANT(S) DETAILS

Company Name/Surname	1.1	ADANI MINING PTY LTD
----------------------	-----	----------------------

Given Name(s)	1.2	
---------------	-----	--

ACN (if company)	1.3	145 455 205
------------------	-----	-------------

If Tenant in Common, specify share or interest - Percentage	1.4	100.00 %
---	-----	----------

Company Name/Surname	1.1	
----------------------	-----	--

Given Name(s)	1.2	
---------------	-----	--

ACN (if company)	1.3	
------------------	-----	--

If Tenant in Common, specify share or interest - Percentage	1.4	0.00 %
---	-----	--------

Company Name/Surname	1.1	
----------------------	-----	--

Given Name(s)	1.2	
---------------	-----	--

ACN (if company)	1.3	
------------------	-----	--

If Tenant in Common, specify share or interest - Percentage	1.4	0.00 %
---	-----	--------

Company Name/Surname	1.1	
----------------------	-----	--

Given Name(s)	1.2	
---------------	-----	--

GUIDE FOR APPLICANTS

Before making an application you are required to mark out the land proposed for the mining lease. For the manner of marking out, refer to sections 240 and 241 of the *Mineral Resources Act 1989*.

Question 1.1

Specify company name or surname of applicant(s).

Question 1.2

Specify given name(s) of applicant(s).

Question 1.3

If a company, what is the Australian Company Number (ACN)?

GUIDE FOR APPLICANTS

Question 1.4

Specify the percentage of interest to be held by each applicant.

ACN (if company)	1.3	
If Tenant in Common, specify share or interest - Percentage	1.4	0.00 %
Total Percentage	1.5	100.00 %

Question 1.5

The total interest must equal 100%. If you are entering these details online, right click the '0' and select 'Update Field'.

Tenancy	1.6	Tenants in Common <input checked="" type="checkbox"/>	Joint Tenants <input type="checkbox"/>
---------	-----	---	--

Question 1.6

If there are 2 or more applicants, indicate if the interests will be held as Tenants in Common or as Joint Tenants. If interests are not specified, tenancy will be registered as Tenants in Common.

NOTE: Joint Tenants must be of equal interest held.

Nominated Person	1.7	A THOMPSON of MTS Authorised Agents
------------------	-----	-------------------------------------

Address	1.8	GPO BOX 215 BRISBANE QLD 4001
---------	-----	----------------------------------

Question 1.7

One applicant must be shown as the nominated person, upon whom any notice may be served on behalf of the applicant(s). (Commonly referred to as the 'Principal Holder')

Phone Number	1.9	(07) 3229 1707
--------------	-----	------------------

Fax Number	1.10	(07) 3229 6222
------------	------	------------------

Question 1.8

Specify the address of the nominated applicant.

E-mail	1.11	athompson@miningtenement.com.au
--------	------	---------------------------------

Question 1.9

Specify the phone number of the nominated applicant.

Question 1.10

Specify the fax number of the nominated applicant.

Question 1.11

Specify the email address of the nominated applicant.

Question 2

A mining lease can be applied for if the applicant (or one of the applicants) is the holder of a current pre-requisite tenure.

Question 2.1-2.5

Tick which is the pre-requisite tenure for the mining lease application either a prospecting permit, exploration permit for mineral or coal, mineral development licence or a mining claim or mining lease (being conditionally surrendered) and provide the number and expiry date of the tenure.

A conditional surrender may be for the whole or part of the area in favour of either whole or part of a new application.

Question 2.6

Identify whether the land is situated within an exploration permit, geothermal exploration permit or mineral development licence (either granted or an application) that is not held by you.

If so, you must obtain the earlier applicant's or holders written views on your application and lodge those views with the Mining Registrar. (Refer to sections 248 and 249 of the *Mineral Resources Act 1989*).

2. PRE-REQUISITE TENURE DETAILS

What pre-requisite tenure do you hold over this area?

		Tick		Number(s)	Expiry Date(s)
		Mineral	Coal		
2.1	Prospecting Permit	<input checked="" type="checkbox"/>		73961,73962, 73963,73964, 73965,73966, 73967	20 / 12 / 2012
2.2	Exploration Permit(s)	<input type="checkbox"/>	<input type="checkbox"/>		/ /
2.3	Mineral Development Licence(s)	<input type="checkbox"/>	<input type="checkbox"/>		/ /
2.4	Conditionally surrendered Mining Claim	<input type="checkbox"/>			/ /
2.5	Conditionally surrendered Mining Lease	<input type="checkbox"/>			/ /

Is the land applied for situated within an area of an Exploration Permit for Mineral or Coal, a Geothermal tenure or a Mineral Development Licence, which you are not the holder?

2.6	<input checked="" type="checkbox"/> YES (go to Q 2.7) <input type="checkbox"/> NO (go to Q 3.1)
-----	---

		Tick		Number(s)	Expiry Date(s)
		Mineral	Coal		
2.7	Exploration Permit(s)	<input type="checkbox"/>	<input checked="" type="checkbox"/>	1080	1 / 11 / 2012
2.8	Mineral Development Licence(s)	<input type="checkbox"/>	<input type="checkbox"/>		/ /

GUIDE FOR APPLICANTS

Question 2.7 to 2.9

If yes, provide number and expiry date of relevant tenure not held by you.

Question 3

Before you apply for a mining lease you must mark out the boundary of the land, even if the surface of the land is not going to be included in your application.

Once marked out you have five business days in which to lodge your application.

Question 3.1-3.2

Specify the date and time the land the subject of the mining lease was marked out.

Question 3.3

There is no restriction on the term of a mining lease. However, when you apply for a lease you must justify the term you are seeking. A mining lease cannot be for a term longer than the period for which compensation has been agreed or decided. For example, if you agree to compensation for a five-year period then the lease cannot exceed five years.

Question 3.4

Provide detailed reasons for the length of term sought.

Question 3.5 & 3.6

State the area of land being applied for. There are no restrictions on the area and shape of the land, which can be granted under a mining lease (other than those imposed under certain Restricted Areas). However, you must justify the area and shape when you make your application.

Question 3.7

State the general locality of the application, e.g. 15km SE of Mount Isa.

Question 3.8

Insert the name of the Mining Lease.

Question 3.9

Insert the details of the Local Government. This refers to either the City or Shire Council responsible for the local government area(s) in which the land is situated.

Question 3.10

Specify which minerals are sought and/or the purpose for the mining lease. Do not use symbols. Do not include minerals that are not specified in the pre-requisite tenure.

Please Note: the Government's policy is that it will not grant mining tenements for the purpose of mining uranium in Queensland, nor will it permit the treatment or processing of uranium within the State.

3. APPLICATION DETAILS

What was the date and time the land was marked out?

3.1	DATE: 23 / 11 / 2012	3.2	TIME: 4.30	<input type="checkbox"/> AM <input checked="" type="checkbox"/> PM
-----	----------------------	-----	------------	---

Term applied for:

3.3	30 years
-----	----------

Provide detailed reasons the term applied for.

3.4	TO ALLOW SUFFICIENT TIME TO CARRY OUT THE MINING OF THE COAL RESOURCE IDENTIFIED AND TO MATCH THE TERM OF THE ABUTTING ML 70441
-----	---

Size of area applied for

3.5	16875	ha
-----	-------	----

Provide detailed reasons for the area and shape of the land applied for.

3.6	TO COVER THE RESOURCE IDENTIFIED FROM THE EXPLORATION CARRIED OUT ON THE EPC AND ALLOW FOR REQUIRED INFRASTRUCTURE
-----	--

What is the general locality of this application?

3.7	APPROX 200 KM SOUTH EAST OF PENTLAND
-----	--------------------------------------

What is the name of the Mining Lease? (if any)

3.8	CARMICHAEL EAST
-----	-----------------

What is the local government area(s) in which the land applied for is situated?

3.9	ISAAC REGIONAL COUNCIL
-----	------------------------

Specify the minerals and/or purpose for which this mining lease is sought?

3.10	COAL
------	------

Is the application solely for infrastructure facilities associated with mining? (e.g. Workshops, administration buildings)

3.11	<input type="checkbox"/> YES	<input checked="" type="checkbox"/> NO
------	------------------------------	--

GUIDE FOR APPLICANTS

NOTE: Coal mining leases are subject to additional provisions imposed under Part 7AA of the *Mineral Resources Act 1989*.

Question 3.11

Mining leases may be granted for purposes other than mining of minerals (i.e. for the purposes of carrying out activities associated with mining such as plant site, camp or tailings dam).

Question 4

The *Mineral Resources Act 1989* prescribes certain types of land as "restricted land". This land is only available if the owner of the land where the relevant permanent building (Category A), or feature (Category B) is situated, consents in writing to your application. If consents are not lodged, such areas will automatically be excluded from the surface area of your mining lease.

Restricted Land (category A)
Means land within 100m laterally of a permanent building used –

- (a) mainly as accommodation or for business purposes; or
- (b) for community, sporting or recreational purposes or as a place of worship.

Restricted Land (category B)
Means land within 50m laterally of any of the following features–

- (a) a principal stockyard;
- (b) a bore or artesian well;
- (c) a dam;
- (d) another artificial water storage connected to a water supply; or
- (e) a cemetery or burial place.

Question 4.2

Specify the improvements to the land which is being applied in the mining lease. The types of improvements and prescribed distances are defined in the *Mineral Resources Act 1989*.

Question 5.1

Indicate whether the mining lease is over land that is a reserve as defined in the Schedule - Dictionary of the *Mineral Resources Act 1989*.

Question 5.2

If you are unable to obtain the written views of the owner of the reserve despite efforts to do so, the Land Court of Queensland has the power to make a recommendation to the Minister as to whether the Governor in Council should consent to the grant of the mining lease over the surface of the reserve subject of certain conditions.

Question 5.3

Specify what attempts have been made to obtain consent.

4. RESTRICTED LAND

Are there any permanent buildings or relevant features within the boundaries of the land applied for or within the prescribed distances laterally of the boundaries? _

4.1	<input checked="" type="checkbox"/> YES (go to Q 4.2)	<input type="checkbox"/> NO (go to Q 5.1)
-----	---	---

What are those permanent buildings or relevant fixtures?

4.2	SEE ATTACHED MAP
-----	------------------

Do you have the written consent of the owner(s) of the land containing those permanent buildings or relevant fixtures to the land being applied for in the mining lease?

4.3	<input checked="" type="checkbox"/> YES (attach copy)	<input checked="" type="checkbox"/> NO (see below)
-----	---	--

Please note: Consent must be lodged with the Mining Registrar prior to close of objections.

5. RESERVE LAND

Is the application over land the surface of a reserve?

5.1	<input checked="" type="checkbox"/> YES (go to Q 5.2)	<input type="checkbox"/> NO (go to Q 6.1)
-----	---	---

Do you have written consent of the owner(s) of the reserve?

5.2	<input type="checkbox"/> YES (go to Q 6.1)	<input checked="" type="checkbox"/> NO (go to Q 5.3)
-----	--	--

If yes – please attach a copy of consent.

If NO, what action has been taken to obtain such written consent?

5.3	CONSENT IS TO BE SOUGHT FROM THE LOCAL AUTHORITY TO INCLUDE THE ROAD RESERVES IN THE AREA OF THE ML.
-----	--

Please note: Consent must be lodged with the Mining Registrar prior to close of objections.

6. BACKGROUND LAND TENURE DETAILS

Describe the land parcels that are the subject of the application for mining lease:

Lot Number	6.1	662	Plan Number	6.2	PH 1491
Land Tenure Type	6.3	LEASED LAND - PASTORAL HOLDING PH 662			
Current Usage	6.4	CATTLE GRAZING AND BREEDING			
Owner's Name	6.5	ADANI MINING PTY LTD			
Owner's Address	6.6	LEVEL 30, 10 EAGLE STREET BRISBANE, QLD, 4000			

GUIDE FOR APPLICANTS

Question 6

Please provide a description of all parcels of land the whole or part of which are covered by your application. It is necessary to provide the landowner's name and address for each parcel of land. You can obtain this information from the Department of the Environment and Resource Management Service Centre.

You are also required to provide details of which parcels of land are within the boundaries of the surface area and access being applied for.

Refer to Schedule - Dictionary in the *Mineral Resources Act 1989* for the definition of an 'owner'

If insufficient space please attach list.

Questions 6.1 & 6.2

Specify the Lot Number and Registered Plan Number of land over which the lease is required.

Question 6.3

Insert land tenure type, e.g. Freehold, special lease, pastoral holding etc.

Question 6.4

What is the land currently used for?

Questions 6.5 & 6.6

Enter the Name and Address of the owner of the land.

Lot Number	6.1	5091	Plan Number	6.2	PH1882
Land Tenure Type	6.3	LEASED LAND - PASTORAL HOLDING PH 5091			
Current Usage	6.4	CATTLE BREEDING AND FATTENING			
Owner's Name	6.5	B.R. & S.E. COBB AND E.C & R.A. SULLIVAN			
Owner's Address	6.6	MELLALUKA CLERMONT, QLD, 4721			

Lot Number	6.1	1	Plan Number	6.2	SP 164918
Land Tenure Type	6.3	LEASED LAND - GHPL 220168			
Current Usage	6.4	CATTLE BREEDING AND FATTENING			
Owner's Name	6.5	D.M. & K.F. LUKE			
Owner's Address	6.6	LIGNUM STATION CLERMONT QLD 4721			

Lot Number	6.1	RESERVE	Plan Number	6.2	
Land Tenure Type	6.3	ROAD RESERVE			
Current Usage	6.4	LAGLAN - LOULOU ROAD			
Owner's Name	6.5	ISAAC REGIONAL COUNCIL			
Owner's Address	6.6	PO BOX 97, MORANBAH, QLD, 4744			

Describe the land parcels over which access to the application for mining lease is required:

Lot Number	6.1	RESERVE	Plan Number	6.2	
Land Tenure Type	6.3	ROAD RESERVE			
Current Usage	6.4	STOCK ROUTE			
Owner's Name	6.5	ISAAC REGIONAL COUNCIL			
Owner's Address	6.6	PO BOX 97. MORANBAH, QLD, 4744			

Lot Number	6.1		Plan Number	6.2	
------------	-----	--	-------------	-----	--

GUIDE FOR APPLICANTS

Question 6

Please provide a description of all parcels of land the whole or part of which are covered by your application. It is necessary to provide the landowner's name and address for each parcel of land. You can obtain this information from the Department of the Environment and Resource Management Service Centre.

You are also required to provide details of which parcels of land are within the boundaries of the surface area and access being applied for.

Refer to Schedule - Dictionary in the *Mineral Resources Act 1989* for the definition of an 'owner'

If insufficient space please attach list.

Questions 6.1 & 6.2

Specify the Lot Number and Registered Plan Number of land over which the lease is required.

Question 6.3

Insert land tenure type, e.g. Freehold, special lease, pastoral holding etc.

Question 6.4

What is the land currently used for?

Questions 6.5 & 6.6

Enter the Name and Address of the owner of the land.

Lot Number	6.1		Plan Number	6.2	
Land Tenure Type	6.3				
Current Usage	6.4				
Owner's Name	6.5				
Owner's Address	6.6				

Lot Number	6.1	RESERVE	Plan Number	6.2	
Land Tenure Type	6.3	ROAD RESERVE			
Current Usage	6.4	UNNAMED ROAD			
Owner's Name	6.5	ISAAC REGIONAL COUNCIL			
Owner's Address	6.6	PO BOX 97, MORANBAH, QLD, 4744			

Lot Number	6.1	RESERVE	Plan Number	6.2	
Land Tenure Type	6.3	ROAD RESERVE			
Current Usage	6.4	MORAY - CARMICHAEL BOUNDARY ROAD			
Owner's Name	6.5	ISAAC REGIONAL COUNCIL			
Owner's Address	6.6	PO BOX 97, MORANBAH, QLD, 4744			

Describe the land parcels over which access to the application for mining lease is required:

Lot Number	6.1		Plan Number	6.2	
Land Tenure Type	6.3				
Current Usage	6.4				
Owner's Name	6.5				
Owner's Address	6.6				

Lot Number	6.1		Plan Number	6.2	
------------	-----	--	-------------	-----	--

GUIDE FOR APPLICANTS

Question 7.1

If the applicant is not the owner of the land over which the surface of the application is made, then compensation must be entered into prior to grant either by written agreement or determined by the Land Court of Queensland of Queensland. Access land is also subject to the compensation requirements of the Act.

Any compensation agreement must be signed by all parties, stamped by the Office of State Revenue and filed with the Mining Registrar.

Question 7.2

Compensation is not required if the background land tenure is "Unallocated State Land" or is owned by the applicant. If the applicant is the owner, proof of ownership is required to be lodged with the application.

Question 8.1

Fully describe the reference/start point of the land so that it can be accurately located. Either by a survey mark or other fixed and well defined point. Preferably a GPS point.

GPS Points must be in latitude and longitude on GDA94 Datum or MGA94 (Easting, Northing, Zone)

Question 8.2

Indicate which corner the datum post is located, e.g. NW corner.

Question 8.3

Enter description of the reference start point. In describing the reference point, all bearings are to be magnetic. If there is insufficient space, please attach a list.

Question 8.4

Enter the compass bearing taken along the centreline of the reference/start point.

Question 8.5

Enter the distance, in metres, from the reference/start point on the compass bearing.

Question 8.6

The posts used to mark out the mining lease must have the applicant's initials along with the date of marking out. Indicate the initials and date marked on each post (Refer to section 241 of the *Mineral Resources Act 1989*).

Land Tenure Type	6.3	
Current Usage	6.4	
Owner's Name	6.5	
Owner's Address	6.6	

7. COMPENSATION AGREEMENT DETAILS

Is a compensation agreement required?

7.1	<input checked="" type="checkbox"/> YES (go to Q 8.1)	<input type="checkbox"/> NO (go to Q 7.2)
-----	---	---

Why is a compensation agreement not required?

7.2	
-----	--

8. LOCATION DESCRIPTION

Describe the location of the Reference/Start Point of the land applied for.

8.1	SEE ATTACHED
-----	--------------

In which corner of the lease is the Datum Post located?

8.2	A WESTERN CORNER
-----	------------------

Describe the connection from the Reference/Start Point to the Datum Post:

Commencing from the reference start point:

8.3	SEE ATTACHMENT
-----	----------------

at a bearing of	8.4		for a distance of	8.5		metres,
at a bearing of	8.4		for a distance of	8.5		metres,
at a bearing of	8.4		for a distance of	8.5		metres,
at a bearing of	8.4		for a distance of	8.5		metres,
at a bearing of	8.4		for a distance of	8.5		metres,
at a bearing of	8.4		for a distance of	8.5		metres,
at a bearing of	8.4		for a distance of	8.5		metres,

to the Datum Post.

GUIDE FOR APPLICANTS

Question 9

You must describe the boundaries of the mining lease by accurately measured distances and compass bearings. All bearings are to be magnetic and clockwise and the description should indicate any abutments, for example, a bearing of 90° 00' for a distance of 100 metres to and abutting the western boundary of ML 70045.

You must also include a sketch map, or other graphic representation acceptable to the Mining Registrar setting out the boundaries of the land being applied for and the land required as access. This map should also show any mining claims, mineral development licences, or mining leases (or applications for the grant of one of these) within the boundaries of the land being applied for

Question 9.1

Enter the compass bearing taken.

Question 9.2

Enter the distance, in metres, to the next post.

Question 9.3

Enter description, e.g. North West Corner... etc.

Questions 10.1 & 10.2

If there is existing mining tenure (or prior application for grant of mining tenure) wholly within this application, or if there is an area that you do not wish your application to cover you are required to complete Question 11.2.

What are the markings on all the posts? (Initials and surname of one applicant or company initials and Date)

8.6	AMPL 23-12 -2012
-----	------------------

9. EXTERNAL BOUNDARY DESCRIPTION

Describe the external boundaries of the land applied for in this application.

Commencing from the datum post:

at a bearing of	9.1		for a distance of	9.2		m,
to	9.3	SEE ATTACHED EXTERNAL BOUNDARY DESCRIPTION				thence
at a bearing of	9.1		for a distance of	9.2		m,
to	9.3					thence
at a bearing of	9.1		for a distance of	9.2		m,
to	9.3					thence
at a bearing of	9.1		for a distance of	9.2		m,
to	9.3					thence
at a bearing of	9.1		for a distance of	9.2		m,
to	9.3					thence
at a bearing of	9.1		for a distance of	9.2		m,
to	9.3					thence
at a bearing of	9.1		for a distance of	9.2		m,
to	9.3					thence
at a bearing of	9.1		for a distance of	9.2		m,
to	9.3					thence

back to the point of commencement.

10. INTERNAL BOUNDARY CONNECTION AND DESCRIPTION

Is there an existing mining tenure (or prior application for grant of a mining tenure) wholly within this application?

10.1	<input type="checkbox"/>	YES (go to Q 10.2)	<input checked="" type="checkbox"/>	NO (go to Q 11)
------	--------------------------	--------------------	-------------------------------------	-----------------

Provide the tenure details of existing mining tenure:

10.2	Tick	Number(s)	Expiry Date(s)
Mining Claim	<input type="checkbox"/>		/ /
Mining Lease	<input type="checkbox"/>		/ /
Mineral Development Licence(s)	Mineral <input type="checkbox"/>		/ /
	Coal <input type="checkbox"/>		

GUIDE FOR APPLICANTS

Questions 10.3 to 10.6

If there is a mining claim, mineral development licence or mining lease or an application for one of these tenements already within the area you are applying for, then the datum post or commencement post of the mining claim, mineral development licence or mining lease (or applications) must be related to the commencement point of your mining lease application by accurately measured distances and compass bearings.

The Mining Registrar may accept alternative methods instead of measured distances and bearings where these are more accurate.

All bearings are to be magnetic and the description should indicate any abutments. For example, "at a bearing of 90° 00' for a distance of 100 metres to the...".

Please attach a separate list if insufficient space

Question 10.7 to 10.10

All bearings are to be magnetic and clockwise and the description should indicate any abutments, for example, "at a bearing of 90° 00' for a distance of 100 metres to the western boundary of ML 70045".

Please attach separate list if insufficient space.

Questions 11.1 to 11.3

Indicate if surface area is required, if so, state reasons why surface area is required and whether surface area is applied for over whole or part of the mining lease.

Describe the connection from the Commencement Point of this application to the Datum Post/commencement point of the interior tenure.

From the Commencement Point of this application

at a bearing of for a distance of m,

to thence

at a bearing of for a distance of m,

to thence

at a bearing of for a distance of m,

to thence

at a bearing of for a distance of m,

to thence

to the Datum Post/Commencement Point of the interior tenure.

Describe the external boundaries of the interior tenure referred to above.

From the Datum Post / Commencement Point in the

corner of the interior tenure

at a bearing of for a distance of m,

to thence

at a bearing of for a distance of m,

to thence

at a bearing of for a distance of m,

to thence

at a bearing of for a distance of m,

to thence

back to the Datum Post/Commencement Point of the interior tenure.

11. SURFACE AREA CONNECTION AND DESCRIPTION

11.1 Whole (go to Q 11.2) Part (go to Q 11.2) Nil (go to Q 11.2)

Why is surface area required?

11.2 TO CARRY OUT AN OPEN CUT COAL MINING OPERATION AND ALLOW SUFFICIENT AREA FOR INFRASTRUCTURE AND STOCKPILING ETC.

Whole (go to Q 12) Part (go to Q 11.3)

11.3 If part - what area is required? ha (go to Q 11.4)

GUIDE FOR APPLICANTS

Questions 11.4 to 11.7
All bearings are to be magnetic.

Please attach separate list if insufficient space.

Describe the connection from a Datum Post of this application to the initial corner of the surface area.

Commencing from the Datum Post located at 11.4 _____

at a bearing of 11.5 _____ for a distance of 11.6 _____ 0 m,

to 11.7 SEE ATTACHED SURFACE AREA DESCRIPTION thence

at a bearing of 11.5 _____ for a distance of 11.6 _____ m,

to 11.7 _____ thence

at a bearing of 11.5 _____ for a distance of 11.6 _____ m,

to 11.7 _____ thence

at a bearing of 11.5 _____ for a distance of 11.6 _____ m,

to 11.7 _____ thence

at a bearing of 11.5 _____ for a distance of 11.6 _____ m,

to the initial corner of the surface area.

Question 11.8 to 11.11

It is not necessary to mark out the boundary of the surface area if part only of the surface is going to be included in your application. However, the boundary of the surface area must be described by measuring the distance on the ground and by taking compass bearings. The description must be related to a boundary post by accurately measured distances and compass bearings.

All bearings are to be magnetic and distances are to be in metres.

Please attach a separate list if insufficient space.

Describe the Surface Area of the land being applied for:

From the initial corner of the surface area 11.8 _____

at a bearing of 11.9 _____ for a distance of 11.10 _____ m,

to 11.11 _____ thence

at a bearing of 11.9 _____ for a distance of 11.10 _____ m,

to 11.11 _____ thence

at a bearing of 11.9 _____ for a distance of 11.10 _____ m,

to 11.11 _____ thence

at a bearing of 11.9 _____ for a distance of 11.10 _____ m,

to 11.11 _____ thence

at a bearing of 11.9 _____ for a distance of 11.10 _____ m,

to 11.11 _____ thence

at a bearing of 11.9 _____ for a distance of 11.10 _____ m,

to 11.11 _____ thence

at a bearing of 11.9 _____ for a distance of 11.10 _____ m,

back to the point of commencement.

Question 11.12

If no surface area is required to gain access to the area applied for in this application, provide details of your adjoining mining lease(s) that will enable you to gain access to the proposed area.

11.12	If no surface area is required, give details of the adjoining granted mining lease(s) held by you that will enable you to gain access to the area applied for in this application.	
	Mining Lease Number(s)	Holder Name(s)

GUIDE FOR APPLICANTS

Question 13

Compliance with the native title provisions of the *Commonwealth Native Title Act 1993* is not necessary on land where native title is taken to have been extinguished (i.e. 'exclusive' land tenures).

However, if you wish to include in your application land that may be subject to native title (i.e. 'non-exclusive' land tenures), you must comply with the relevant native title procedure irrespective as to whether or not a native title claim has been lodged over the area.

Question 14.1

Enter the name of place where the application was signed, the day of the month, the month and the year when the form is signed.

Question 14.2

Insert full name of the applicant(s).

Question 14.3

Signature of applicant(s).

Question 14.4

Insert full name of Witness.

Question 14.5

Signature of Witness.

Execution of Documents by an Agent

If an agent or the holder of a power of attorney is signing a document, required to be lodged by an Act, on behalf of another, the agent or holder of the power of attorney must produce current, written evidence of their authority to act at the time of lodgement.

All of the holders of the tenure MUST execute the appointment of agent or the power of attorney for the appointment or power of attorney to be effective. A company signing an appointment of agent or power of attorney must do so in accordance with the corporation law and/or the articles of association of the company.

13. NATIVE TITLE

Do you believe that the application area (including any access land) is over land tenures that may be subject to Native Title?

13.1	<input checked="" type="checkbox"/> YES (go to Q 13.2)	<input type="checkbox"/> NO (go to Q 14)
------	--	--

If the land applied for is over land tenures where native title may still exist, is the land applied for subject to an Indigenous Land Use Agreement (ILUA)?

13.2	<input type="checkbox"/> YES	<input checked="" type="checkbox"/> NO
------	------------------------------	--

14. SIGNATURES

I/We:

- solemnly sincerely and truly declare that the information provided in this form is true and correct.
- understand that any false or misleading information may attract a maximum penalty of 200 penalty units.

14.1	Signed at BRISBANE this 26th day of NOVEMBER, 2012	
------	--	--

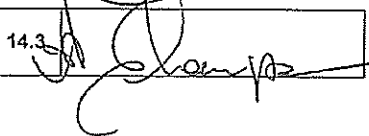
14.2	ADANI MINING PTY LTD	14.3	
	A Thompson - MTS Authorised Agents		

14.2		14.3	

14.2		14.3	

14.2		14.3	

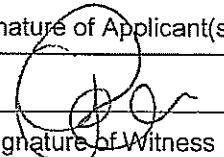
Full name and title of Applicant(s)		Signature of Applicant(s)	
14.4	Carlin Ross	14.5	
Full name of Witness		Signature of Witness	

GUIDE FOR APPLICANTS

15. ACCOMPANIMENTS

15.1 The following must accompany this form:

Question 15.1

Tick the appropriate boxes to indicate compliance.

Question 15.2

Tick the appropriate boxes to indicate compliance.

An annual fee must accompany new applications for Level 1 or Level 2 mining projects.

Refer to the DERM's Website www.derm.qld.gov.au for prescribed/annual fee amounts and appropriate application forms.

Question 15.3

If the application is for the purpose of mining for coal or oil shale or a specific purpose (coal or oil shale), you must ensure the additional accompaniments are lodged with the application.

You must determine whether any part of the application area of your Mining Lease is within the tenure area of a pre-existing petroleum lease or authority to prospect.

Refer to section 7AA of the *Mineral Resources Act 1989*. If so, separate applications may need to be lodged.

Mining lease (coal) means a mining lease for coal, whether or not the lease specifies any other mineral to be mined, and whether or not the lease is for any additional purpose.

Mining lease (oil shale) means a mining lease for oil shale, whether or not the lease specifies any other mineral to be mined, and whether or not the lease is for any additional purpose.

Specific purpose mining lease (coal or oil shale) means a mining lease, other than a mining lease (coal or oil shale), granted under section 234(1)(b), if the purposes for which it is granted include a purpose that is associated with, arises from or promotes the activity of coal or oil shale mining.

Specific purpose mining lease (oil shale) means a mining lease, other than a mining lease (oil shale), granted under section 234(1)(b), if the purposes for which it is granted include a purpose that is associated with, arises from or promotes the activity of oil shale mining.

Departmental Guidelines for initial and later development plans are available at www.dme.qld.gov.au/mines/guidelines.cfm

	Tick
<ul style="list-style-type: none"> • A statement: <ul style="list-style-type: none"> ○ Outlining the mining program proposed, outlining its method of operation, and providing an indication of when operations are expected to start; or ○ If a mining program is not proposed, outline the use proposed for the land and provide an indication of when the proposed use is to start; and <p><i>(Note: The above information is not required if, under part 7AA, if your application includes a proposed development plan that complies with the initial development plan requirements)</i></p> <ul style="list-style-type: none"> ○ Of proposals for infrastructure requirements necessary to enable the mining program to proceed, or additional activities to be carried on to work out the infrastructure requirements; and ○ Specifying the estimated human, technical and financial resources proposed to be committed for the term of the lease. 	<input checked="" type="checkbox"/> or <input type="checkbox"/>
<ul style="list-style-type: none"> • A statement detailing the applicant's financial and technical resources however separate from the statements mentioned above. 	<input checked="" type="checkbox"/>
<ul style="list-style-type: none"> • Sketch map(s) or other graphic representation setting out: <ul style="list-style-type: none"> ○ the boundaries of the land the subject of this application; ○ proposed surface area; ○ location of datum post and start/reference point; ○ the proposed access; and ○ any Mining Claim, Mineral Development Licence or Mining Lease (or application for grant of same) wholly within the land sought. 	<input checked="" type="checkbox"/>
<ul style="list-style-type: none"> • Proof of identity of the Applicant(s) 	<input checked="" type="checkbox"/>
<ul style="list-style-type: none"> • The prescribed application fee 	<input checked="" type="checkbox"/>

15.2 Department of Environment and Resource Management requirements:

<ul style="list-style-type: none"> • A completed application form 	<input checked="" type="checkbox"/>
<ul style="list-style-type: none"> • The prescribed fee/s 	<input checked="" type="checkbox"/>

15.3 Coal or Oil Shale applications require the following additional accompaniments:

<ul style="list-style-type: none"> ▪ A proposed <i>development plan</i> which complies with the initial development plan requirements (sections 318DT and 318DV) and the requirements of either A, B, C or D below. 	<input checked="" type="checkbox"/>
<ul style="list-style-type: none"> ▪ Prescribed development plan fee 	<input checked="" type="checkbox"/>

GUIDE FOR APPLICANTS

Question 15.4

You must determine whether any part of the application area of your Mining Lease is within the tenure area of a pre-existing GHG tenure.

Refer to section 7AAC of the *Mineral Resources Act 1989*.

GHG Act means *Greenhouse Gas Storage Act 2009*.

GHG Tenure means a GHG exploration permit (also known as a GHG permit) or a GHG injection and storage lease (also known as a GHG lease)

<p>A. If the application is within an area of an authority to prospect for petroleum and is being made jointly with, or with the consent of the authority to prospect holder, the following must be lodged:</p> <ul style="list-style-type: none"> o A Coal Seam Gas (CSG) Statement; o Other information that addresses the CSG assessment criteria; and o Written consent (if applicable) or 	<input type="checkbox"/> <input type="checkbox"/> <input type="checkbox"/>
<p>B. If the application is within an area of an authority to prospect for petroleum and is being made other than jointly with, or with the consent of the authority to prospect holder, the following must be lodged:</p> <ul style="list-style-type: none"> o A Coal Seam Gas (CSG) Statement; o Other information that addresses the CSG assessment criteria; and o Written consent (if applicable) or 	<input checked="" type="checkbox"/> <input type="checkbox"/> <input type="checkbox"/>
<p>C. If the application is within an area of a petroleum lease and is being made other than jointly with, or with the consent of the lease holder, the following must be lodged:</p> <ul style="list-style-type: none"> o A Coal Seam Gas (CSG) Statement or 	<input type="checkbox"/>
<p>D. If the application is within an area of a petroleum lease and is being made jointly with the petroleum leaseholder, the following must be lodged:</p> <ul style="list-style-type: none"> o A Coal Seam Gas (CSG) Statement. 	<input type="checkbox"/>

15.4 Additional accompaniments for applications overlapping with a GHG tenure issued under the GHG Act:

<ul style="list-style-type: none"> ▪ A GHG Statement that complies with section 318ELAS. 	<input type="checkbox"/>
<ul style="list-style-type: none"> ▪ Other information that addresses the GHG assessment criteria (section 318ELAR(2)). 	<input type="checkbox"/>

Disclaimer

The Department of Employment, Economic Development and Innovation is collecting information provided on this form for the purposes of assessing the suitability of your application for mining lease and maintain the public searchable register under the *Mineral Resources Act 1989* ('the Act'). This information is authorised by sections 245 and 387 of the Act. Some or all of this information may be provided to the Department of Environment and Resource Management for the issuing of an environmental authority, or through arrangements with other government agencies authorised to make register searches, extracts or copies under section 387B of the Act. Your personal information will not otherwise be disclosed to any other third party without your consent, unless authorised or required by law.

*Attachments to Mining Lease
Application*

July 4, 2013

Mining Lease Application – “Carmichael East”

8. Location Description

- 8.1 The Reference Point of the land applied for is Stn 52 on SP164918
GDA94 E: 444266.8 / N: 7552780.8
- 8.3 The Reference Point and the Datum Post are coincident.
- 8.6 All posts are marked “AMPL 04/07/2013”.

9. External Boundary Description

Commencing from the Datum Post:

At a bearing of 87°28' for a distance of 851.8 metres, coinciding with the boundary of Lot 1 on SP 164918 and Lot 3 on DR17, thence,

(GDA94 E:444266.8 / N:7552780.8)

At a bearing of 171°37' for a distance of 7585.7 metres, Abutting EPC1528 and coinciding with the eastern boundary of Subblocks CLER1830N, CLER1830S, CLER1830X, CLER1902C and CLER1902H thence,

(GDA94 E:445114.4 / N:7552697.0)

At a bearing of 81°37' for a distance of 1718.0 metres, Abutting EPC1528 and coinciding with the northern boundary of Subblocks CLER1902O, thence,

(GDA94 E:445141.4 / N:7545111.3)

At a bearing of 171°38' for a distance of 1845.0 metres, Abutting EPC1528 and coinciding with the eastern boundary of Subblocks CLER1902O, thence,

(GDA94 E:446859.4 / N:7545117.3)

At a bearing of 81°39' for a distance of 1717.6 metres, Abutting EPC1528 and coinciding with the northern boundary of Subblocks CLER1902U, thence,

(GDA94 E:446865.4 / N:7543272.3)

At a bearing of 171°37'45" for a distance of 15880.3 metres, Abutting EPC1528 and coinciding with the eastern boundary of Subblocks CLER1902U, CLER1902Z, CLER1974E, CLER1974K, CLER1974P, CLER1974U, CLER1974Z, CLER2046E and CLER2046K to the intersection of cadastral boundary between Lot 5091 on PH 1882 and Lot 2093 on PH 1883, thence,

(GDA94 E:448583.2 / N:7543278.2)

At a bearing of 232°32' for a distance of 1487.8 metres, coinciding with the boundary between Lot 5091 on PH 1882 and Lot 2093 on PH 1883 to the intersection of the northern boundary of Subblocks CLER2046P, thence,

(GDA94 E:448635.7 / N:7527398.0)

At a bearing of 261°37' for a distance of 415.8 metres, Abutting EPC1528 and coinciding with the northern boundary of Subblocks CLER2046P, thence,

(GDA94 E:447338.1 / N:7526670.2)

July 4, 2013

At a bearing of 351°37'45" for a distance of 9224.0 metres, Abutting EPC1078 and coinciding with the eastern boundary of Subblocks CLER2046D, CLER2046J, and CLER1974O, CLER1974T and CLER1974Y, thence,

(GDA94 E:446922.2 / N:7526669.1)

At a bearing of 261°37' for a distance of 1717.1 metres, Abutting EPC1078 and coinciding with the northern boundary of Subblocks CLER1974O, thence,

(GDA94 E:446890.7 / N:7535893.1)

At a bearing of 351°36' 55" for a distance of 5535.2 metres, Abutting EPC1078 and coinciding with the eastern boundary of Subblocks CLER1902X, CLER1974C, and CLER1974H, thence,

(GDA94 E:445173.6 / N:7535887.1)

At a bearing of 261°36' for a distance of 1717.6 metres, Abutting EPC1078 and coinciding with the northern boundary of Subblocks CLER1902X, thence,

(GDA94 E:445154.4 / N:7541422.3)

At a bearing of 351°36'30" for a distance of 9224.9 metres, Abutting MLA70441 and coinciding with the eastern boundary of Subblocks CLER1830W, CLER1902B, CLER1902G, CLER1902M, and CLER1902R, thence,

(GDA94 E:443436.8 / N:7541415.8)

At a bearing of 261°36' for a distance of 1718.7 metres, Abutting MLA70441 and coinciding with the northern boundary of Subblocks CLER1830W, thence,

(GDA94 E:443403.2 / N:7550639.8)

At a bearing of 351°36' for a distance of 1845.1 metres, Abutting MLA70441 and coinciding with the eastern boundary of Subblock CLER1830Q, thence,

(GDA94 E:441684.4 / N:7550633.2)

At a bearing of 261°36' for a distance of 1718.2 metres, Abutting MLA70441 and coinciding with the northern boundary of Subblock CLER1830Q, thence,

(GDA94 E:441677.6 / N:7552478.3)

At a bearing of 351°36'30" for a distance of 3689.5 metres, Abutting MLA70441 and coinciding with the eastern boundary of Subblocks CLER1829K and CLER1829P, thence,

(GDA94 E:439959.4 / N:7552472.0)

At a bearing of 261°36' for a distance of 1719.1 metres, Abutting MLA70441 and coinciding with the northern boundary of Subblock CLER1829K, thence,

(GDA94 E:439944.8 / N:7556161.4)

At a bearing of 351°35' for a distance of 1845.0 metres, Abutting MLA70441 and coinciding with the eastern boundary of Subblock CLER1829D, thence,

(GDA94 E:438225.7 / N:7556154.9)

At a bearing of 261°35' for a distance of 1718.7 metres, Abutting MLA70441 and coinciding with the northern boundary of Subblock CLER1829D, thence,

(GDA94 E:438218.3 / N:7557999.9)

July 4, 2013

At a bearing of 351°35' for a distance of 9223.7 metres, Abutting MLA70441 and coinciding with the eastern boundary of Subblocks CLER1757C, CLER1757H, CLER1757N, CLER1757S, and CLER1757X, thence,
(GDA94 E:436499.6 / N:7557992.7)

At a bearing of 261°35'45" for a distance of 3441.4 metres, Abutting MLA70441 and coinciding with the northern boundary of Subblocks CLER1757B and CLER1757C , thence,
(GDA94 E:436461.6 / N:7567216.3)

At a bearing of 351°34' for a distance of 1844.7 metres, Abutting MLA70441 and coinciding with the eastern boundary of Subblock CLER1685V, thence,
(GDA94 E:433020.2 / N:7567203.1)

At a bearing of 261°34' for a distance of 1720.2 metres, Abutting MLA70441 and coinciding with the northern boundary of Subblock CLER1685V, thence,
(GDA94 E:433012.7 / N:7569047.8)

At a bearing of 351°34' for a distance of 1844.8 metres, Abutting MLA70441 and coinciding with the eastern boundary of Subblock CLER1684U, thence,
(GDA94 E:431292.5 / N:7569040.4)

At a bearing of 261°33' for a distance of 1720.3 metres, Abutting MLA70441 and coinciding with the northern boundary of Subblock CLER1684U, thence,
(GDA94 E:431284.7 / N:7570885.2)

At a bearing of 351°32' for a distance of 1845.8 metres, Abutting MLA70441 and coinciding with the eastern boundary of Subblock CLER1684O, thence,
(GDA94 E:429564.4 / N:7570877.0)

At a bearing of 261°32' for a distance of 1720.5 metres, Abutting MLA70441 and coinciding with the northern boundary of Subblock CLER1684O, thence,
(GDA94 E:429555.2 / N:7572722.8)

At a bearing of 351°34' for a distance of 3690.9 metres, Abutting MLA70441 and coinciding with the eastern boundary of Subblocks CLER1684C and CLER1684H , thence,
(GDA94 E:427834.7 / N:7572714.3)

At a bearing of 81°34' for a distance of 3443.0 metres, Abutting EPC1483 and coinciding with the northern boundary of Subblocks CLER1684D and CLER1684E , thence,
(GDA94 E:427817.5 / N:7576405.1)

At a bearing of 171°34' for a distance of 3690.0 metres, Abutting EPC1957 and coinciding with the eastern boundary of Subblocks CLER1684E and CLER1684K , thence,
(GDA94 E:431260.2 / N:7576420.0)

At a bearing of 81°34' for a distance of 1721.0 metres, Abutting EPC1957 and coinciding with the northern boundary of Subblocks CLER1685L , thence,
(GDA94 E:431276.2 / N:7572730.0)

July 4, 2013

At a bearing of 171°34' for a distance of 1844.7 metres, Abutting EPC1957 and coinciding with the eastern boundary of Subblocks CLER1685L , thence,
(GDA94 E:432997.2 / N:7572737.5)

At a bearing of 81°35' for a distance of 3442.4 metres, Abutting EPC1957 and coinciding with the northern boundary of Subblocks CLER1685R and CLER1685S , thence,
(GDA94 E:433005.1 / N:7570892.8)

At a bearing of 171°37' for a distance of 1844.1 metres, Abutting EPC1957 and coinciding with the eastern boundary of Subblocks CLER1685S , thence,
(GDA94 E:436447.5 / N:7570906.9)

At a bearing of 81°37' for a distance of 1720.9 metres, Abutting EPC1957 and coinciding with the northern boundary of Subblocks CLER1685Y , thence,
(GDA94 E:436454.0 / N:7569062.9)

At a bearing of 171°33' for a distance of 1845.9 metres, Abutting EPC1957 and coinciding with the eastern boundary of Subblocks CLER1685Y , thence,
(GDA94 E:438174.8 / N:7569068.7)

At a bearing of 81°34' for a distance of 1718.5 metres, Abutting EPC1957 and coinciding with the northern boundary of Subblocks CLER1757E , thence,
(GDA94 E:438183.1 / N:7567222.8)

At a bearing of 171°35'15" for a distance of 5534.3 metres, Abutting EPC1957 and coinciding with the eastern boundary of Subblocks CLER1757E, CLER1757K and CLER1757P, thence,
(GDA94 E:439901.6 / N:7567230.6)

At a bearing of 81°37' for a distance of 1719.9 metres, Abutting EPC1957 and coinciding with the northern boundary of Subblocks CLER1758Q , thence,
(GDA94 E:439923.7 / N:7561696.3)

At a bearing of 171°36' for a distance of 1844.4 metres, Abutting EPC1957 and coinciding with the eastern boundary of Subblocks CLER1758Q , thence,
(GDA94 E:441643.6 / N:7561702.1)

At a bearing of 81°36' for a distance of 1718.9 metres, Abutting EPC1957 and coinciding with the northern boundary of Subblocks CLER1758W , thence,
(GDA94 E:441650.8 / N:7559857.7)

At a bearing of 171°36'45" for a distance of 5535.5 metres, Abutting EPC1957 and coinciding with the eastern boundary of Subblocks CLER1758W , CLER1830B ,and CLER1830G , thence,
(GDA94 E:443369.6 / N:7559864.3)

At a bearing of 81°37' for a distance of 1083.7 metres, Abutting EPC1957 and coinciding with the northern boundary of Subblocks CLER1830N Intersecting the cadastral boundary between Lot 662 on PH 1491 and Lot 3 on DR 17, thence,
(GDA94 E:443389.3 / N:7554328.9)

July 4, 2013

At a bearing of 179°24' for a distance of 1566.0 metres, coinciding with the cadastral boundary between Lot 662 on PH 1491 and Lot 3 on DR 17, back to the point of commencement

(GDA94 E:444473.6 / N:7554333.2)

Area – 16875 ha

Area – 16960 ha Total (including roads)

Roads

R-North 31.5 ha

R-Middle 15.2 ha

R-South 15.8 ha

R- Bottom 22.3 ha

Roads Total 84.8 ha

Bearings are Magnetic.

Add 8°11' to magnetic bearings for grid bearings.

(Subject to confirmation by survey).

Prepared by Wilson Survey Group

4th July 2013

Adani Mining Pty Ltd Carmichael Coal Project

Carmichael East
Background Land Tenure Details

TM

Carmichael East

6.1 Lot Number	1	6.2 Plan Number	SP 164918
6.3 Land Tenure Type	Crown leasehold		
6.4 Current Usage	Cattle grazing and breeding		
6.5 Owner's Name	David Michael Luke and Katie Frances Luke		
6.6 Owner's Address	Lingum Station, Clermont, QLD 4721		

6.1 Lot Number	5091	6.2 Plan Number	CP PH 1882
6.3 Land Tenure Type	Crown leasehold		
6.4 Current Usage	Cattle grazing and breeding		
6.5 Owner's Name	Bruce Raymond Cobb, Robert Allan O'Sullivan and Samantha Elizabeth Cobb		
6.6 Owner's Address	Mellaluka Station, Clermont, QLD 4721		

6.1 Lot Number	662	6.2 Plan Number	CP PH1491
6.3 Land Tenure Type	Crown leasehold		
6.4 Current Usage	Cattle grazing and breeding		
6.5 Owner's Name	Adani Mining Pty Ltd		
6.6 Owner's Address	Level 30 AMP Place 10 Eagle St BRISBANE QLD 4000		

6.1 Lot Number	Road reserve	6.2 Plan Number	
6.3 Land Tenure Type	Road		
6.4 Current Usage	Unknown Road across Lot 662 on CP PH1491		

6.5 Owner's Name	Isaac Regional Council
6.6 Owner's Address	PO Box 97 MORANBAH QLD 4744

6.1 Lot Number	Road reserve	6.2 Plan Number	
6.3 Land Tenure Type	Road		
6.4 Current Usage	Moray Carmichael Boundary Road across Lot 662 on CP PH1491		
6.5 Owner's Name	Isaac Regional Council		
6.6 Owner's Address	PO Box 97 MORANBAH QLD 4744		

6.1 Lot Number	Road reserve	6.2 Plan Number	
6.3 Land Tenure Type	Road		
6.4 Current Usage	Unknown Road across Lot 662 on CP PH1491		
6.5 Owner's Name	Isaac Regional Council		
6.6 Owner's Address	PO Box 97 MORANBAH QLD 4744		

6.1 Lot Number	N/A	6.2 Plan Number	
6.3 Land Tenure Type	Road		
6.4 Current Usage	Unknown Road across Lot 509 on CP PH1882		
6.5 Owner's Name	Isaac Regional Council		
6.6 Owner's Address	PO Box 97 MORANBAH QLD 4744		

CORRS CHAMBERS WESTGARTH
ACCOUNTS DEPARTMENT
GPO BOX 9925
BRISBANE QLD 4001

Remove this top section if desired before framing



Certificate of Registration of a Company

This is to certify that

ADANI MINING PTY LTD

Australian Company Number 145 455 205

is a registered company under the Corporations Act 2001 and
is taken to be registered in Queensland.

The company **is limited by shares.**

The company is a **proprietary company.**

The day of commencement of registration is
the twenty-eighth day of July 2010.

Issued by the
Australian Securities and Investments Commission
on this twenty-eighth day of July, 2010.

A handwritten signature in black ink, appearing to read 'A. D'Aloisio'.

Anthony Michael D'Aloisio
Chairman



CERTIFICATE

Our Ref: PP 74037
Contact: Kevin Pokarier
Telephone: (07) 4987 9371
Facsimile: (07) 4987 9333
Email: Kevin.Pokarier@dnrm.qld.gov.au



Queensland
Government

Department of
Natural Resources and Mines

1 May 2013

Adani Mining Pty Ltd
C/- Mining Tenement Services
GPO Box 215
Brisbane Qld 4001

06 MAY 2013

Dear Sir/Madam

PROSPECTING PERMIT NO/S 74037

The holder of the above prospecting permit has informed me that you are the owners of the land subject of the permit.

Accordingly, for your information I enclose herewith a copy of the permit that was issued on 1 May 2013 for a period of three (3) months commencing from 2 May 2013.

During the three (3) month period covered by the permits, the permit holder or his/her authorised agent may enter upon the land for the purpose of marking out land that may be subject to application/s for mining lease/s.

Yours faithfully

Kevin J Pokarier
Mining Registrar, Field and Land Access
Emerald Mining District

Government Building
99 Hospital Road, Emerald
PO Box 245, Emerald
Queensland 4720 Australia
Telephone +61 7 4987 9373
Facsimile + 61 7 4987 9333
Website www.deedi.qld.gov.au

COPY



Part 3
Form Number 3

QUEENSLAND
MINERAL RESOURCES ACT 1989

PARCEL PROSPECTING PERMIT NO 74037

MINING DISTRICT : EMERALD

- 1. Full name and address of holder ADANI MINING PTY LTD
C/- MINING TENEMENT SERVICES
GPO BOX 215
BRISBANE
QLD
4001

the holder of this Prospecting Permit and persons so authorised under the Mineral Resources Act 1989 by the issue of this Permit are permitted to enter upon the land described hereunder but restricted to the area and access specified in the attached sketch.
- 2. Locality APPROX 140KM NORTH WEST OF CLERMONT
- 3. Local Authority Isaac (R)

for the purpose of: PEGGING
- 4. Access through LOT 662 ON PH1491 LEASEHOLD PASTORAL HOLDING 12/662
- 5. Background Land LOT 662 ON PH1491 LEASEHOLD PASTORAL HOLDING 12/662
- 6. Minerals COAL
- 7. Date Grant 01-MAY-2013
- 8. Date Commence 02-MAY-2013
- 9. Date Expires 01-AUG-2013
- 10. Conditions This Prospecting Permit is subject to the prescribed conditions and such other conditions as are imposed or varied from time to time by notice in writing and signed by the Mining Registrar.
- 11. Special Circumstances CONDITIONS AS PRESCRIBED AND ATTACHED : CONSENT INCLUDE THE AREA OF MINING LEASE APPLICATIONS 70487 AND MLA 70490 IN THE PROSPECTING PERMIT LODGED.

Granted this first day of May 2013.

Mining Registrar

CONDITIONS

The holder of the within Prospecting Permit is required to:-

- (a) use, if practicable, only existing roads or tracks on the land to which the permit applies;
- (b) take reasonable steps to ensure no reproductive material of a declared plant is moved onto, within or from the land to which the permit applies. "Declared plant" means a plant that is a declared pest under the *Land Protection (Pest and Stock Route Management) Act 2002* or declared to be a pest under a local law of a local government.
- (c) not allow an animal in the custody of the holder or person to be on the land to which the permit applies unless the land is fenced in a way to prevent the animal from leaving the land or the animal is restrained;
- (d) gain access to occupied land only at a point or points designated by a mining registrar unless the holder has obtained the consent in writing of the owner and has lodged that consent with the mining registrar;
- (e) not discharge a firearm unless the holder has the written consent of the owner of the land and the consent has been lodged with the mining registrar;
- (f) not light an open fire unless the holder has the written consent of the owner of the land and the consent has been lodged with the mining registrar;
- (g) not engage in any form of dredging;
- (h) not enter and be upon the surface of land of an owner within 100 metres laterally of a permanent building used mainly as accommodation, or for business purposes, or for community, sporting or recreational purposes, or as a place of worship, or within 50 metres laterally of a principal stockyard or dam, bore or artesian well or a cemetery or burial place without the written consent of the owner of that land lodged with the mining registrar;
- (i) not enter land within 50m laterally of a place where activities are being carried on under an exploration permit only with the written consent of the exploration permit holder;
- (j) Prior notice of entry to be served. At least 5 business days (or such shorter period as is acceptable to the owner of the land and endorsed on the Notice of Entry) before initial entry is made on land under the authority of a prospecting permit, the holder of the prospecting permit shall notify the owner of intention to enter.
- (k) A holder of a prospecting permit for land may enter the land for-
 - a. purposes necessary to enable the holder to apply for a mining claim or mining lease over the land

The holder may-

- (a) enter and leave the land using a reasonable type of transport; and
- (b) enter and leave the land through land the permit states is access land.

(l) Consent required to enter certain land

1. A parcel prospecting permit holder may enter the surface of a reserve for prospecting purposes only with the written consent of the owner of the reserve.
2. A district prospecting permit holder may enter the surface of occupied land only with the written consent of the owner of the land.
3. Also, a prospecting permit holder may enter occupied land for hand mining only with the written consent of the owner of the land.
4. In addition, a prospecting permit holder may enter restricted land only with the written consent of the owner of the land where the relevant permanent building, or relevant feature, is situated.

Note: Restricted land is defined as follows:

- a) Land within 100 m laterally of a permanent building used –
 - i. mainly as accommodation or for business purposes; or
 - ii. for community, sporting or recreational purposes or as a place of worship.
- b) Land within 50 m laterally of any of the following features –
 - i. a principal stockyard;
 - ii. a bore or artesian well;
 - iii. a dam;
 - iv. another artificial water storage connected to a water supply;
 - v. a cemetery or burial place.

5. Further, a prospecting permit holder may enter land within 50 metres laterally of a place where activities are being carried on under an exploration permit only with the written consent of the exploration permit holder.

- (m) not enter occupied land at night without the written consent of the land owner (you must comply with the owners conditions) OR unless the mining registrar permits entry at night (you must abide by the mining registrars conditions)
- (n) comply with the Code of Environmental Compliance for prospecting permits for purposes of hand mining.

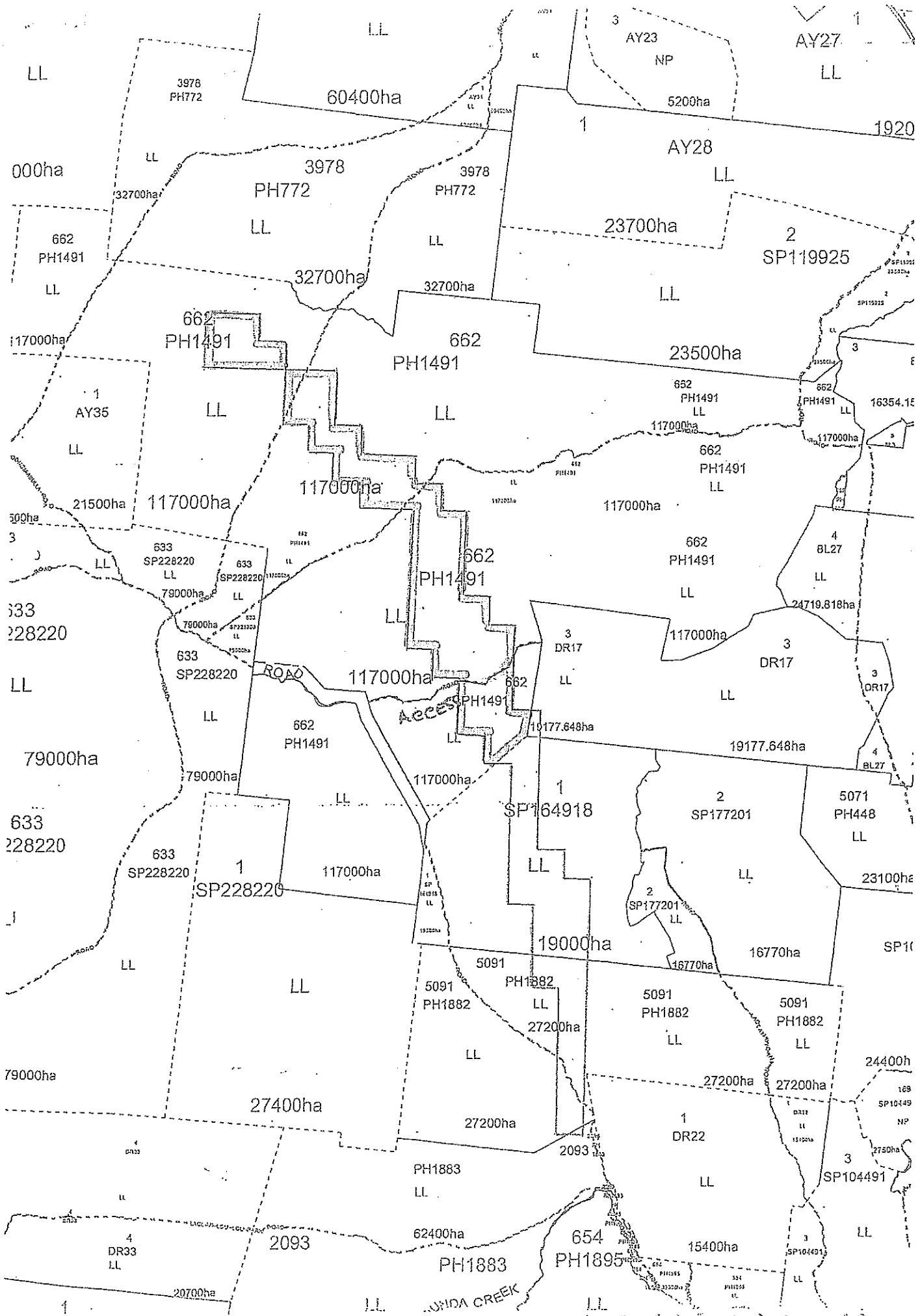

LOT 662 ON PH1491

Our Ref: PP 74036 to 74042
Contact: Kevin Pokarier
Telephone: (07) 4987 9371
Facsimile: (07) 4987 9333
Email: mines.emerald@dnrm.qld.gov.au



Department of
Natural Resources and Mines

1 May 2013

Adani Mining Pty Ltd
C/- Mining Tenement Services
GPO Box 215
Brisbane Qld 4001

Dear Sir/Madam,

I wish to advise that following your applications for prospecting permits, the undermentioned permits have been issued:-

PP 74036 – Lot 5091 on PH1882
PP 74037 – Lot 662 on PH1491
PP 74038 – Lot 1 on RP164018
PP 74039 – Part of Unnamed Road within Lot 5091 on PH882
PP 74040 – Part of Unnamed Road within Lot 662 on PH1491
PP 74041 – Part of Unnamed Road within Lot 662 on PH1491
PP 74042 – Part of Unnamed Road within Lot 662 on PH1491

During the three (3) month period covered by the permits, you or your authorised agent may enter upon the land for the purposes marking out land that may be the subject to an application for a mining lease /s. Your entry onto the land is subject to your compliance with the attached conditions and Section 19 of the *Mineral Resources Act 1989*.

Please note that the Prospecting Permits have only been issued in respect of the parcel or parcels of land nominated in the application.

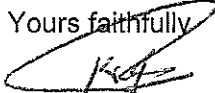
Yours faithfully

Kevin J Pokarier
Mining Registrar, Field and Land Access
Emerald Mining District

Mining Registrar
Department of Natural Resources
and Mines
99 Hospital Road, Emerald
PO Box 245, Emerald
Queensland 4720 Australia
Telephone +61 7 4987 9373
Facsimile + 61 7 4987 9333
Email: mines.emerald@dnrm.qld.gov.au
Website www.dnrm.qld.gov.au



Receipt / Tax Invoice
Department of Natural Resources and Mines

18 Apr 2013 12:54 pm

Page 1 of 1

GRR_200 3.0.9

(ABN: 59 020 847 551)

Receipt Number : EM312507 **Date Payment Received :** 18-APR-2013
Received From : THOMPSON Alan
Address : c/- MTS
 GPO Box 215
 Brisbane
 QLD
 4001

Payment Details

Pay Method: EFTPos Credit Card

Remarks :

APPL FEES PROSPECTING PERMITS.

Description	QTY	Price	GST*	Total Amount
APPLICATION FEE PROS PERMIT PARCEL PP 74041	1	\$106.60	\$0.00	\$106.60
APPLICATION FEE PROS PERMIT PARCEL PP 74040	1	\$106.60	\$0.00	\$106.60
APPLICATION FEE PROS PERMIT PARCEL PP 74042	1	\$106.60	\$0.00	\$106.60
Totals:		\$319.80	\$0.00	\$319.80

Amount Received:	\$319.80
-------------------------	----------

Cashier : Kevin POKARIER

Per Authorised Accounting Officer 

Cheques or other negotiable instruments accepted subject to clearance.

Contact: Emerald District Office - (07) 4987 9373

Business use only

Total Administered: \$319.80

Total Receipt: \$319.80

* GST is a Commonwealth Government Tax; # Refund has been authorised but has not been approved



Receipt / Tax Invoice
Department of Natural Resources and Mines

17 Apr 2013 04:08 pm

Page 1 of 1

GRR_200 3.0.9

(ABN: 59 020 847 551)

Receipt Number : EM312463 **Date Payment Received :** 17-APR-2013

Received From : MINING TENEMENT SERVICES PTY LTD
Address : GPO BOX 215
 BRISBANE
 QLD
 4001

Payment Details

Pay Method: Cheque / Aust. Money Order

Cheque No. : 202440

Bank : WBC

Branch : Queen & Eagle Sts Cnr Queen and Eagle Streets Brisbane
 QLD 4000

Remarks :

PP74036, 74037, 74038, 74039 APPLICATION FOR PROSPECTING PERMITS

Description	QTY	Price	GST*	Total Amount
APPLICATION FEE PROS PERMIT PARCEL PP 74037	1	\$106.60	\$0.00	\$106.60
APPLICATION FEE PROS PERMIT PARCEL PP 74039	1	\$106.60	\$0.00	\$106.60
APPLICATION FEE PROS PERMIT PARCEL PP 74038	1	\$106.60	\$0.00	\$106.60
APPLICATION FEE PROS PERMIT PARCEL PP 74036	1	\$106.60	\$0.00	\$106.60
Totals:		\$426.40	\$0.00	\$426.40

Amount Received:	\$426.40
-------------------------	-----------------

Cashier : Ariana CORKILL

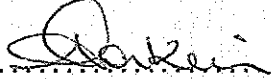
Per Authorised Accounting Officer 

Cheques or other negotiable instruments accepted subject to clearance.

Contact: Emerald District Office - (07) 4987 9373

Business use only

Total Administered: \$426.40

Total Receipt: \$426.40

* GST is a Commonwealth Government Tax; # Refund has been authorised but has not been approved



Part 3
Form Number 3

QUEENSLAND
MINERAL RESOURCES ACT 1989

PARCEL PROSPECTING PERMIT NO 74036

MINING DISTRICT : EMERALD

1. Full name and address of holder
ADANI MINING PTY LTD
C/- MINING TENEMENT SERVICES
GPO BOX 215
BRISBANE
QLD
4001
the holder of this Prospecting Permit and persons so authorised under the Mineral Resources Act 1989 by the issue of this Permit are permitted to enter upon the land described hereunder but restricted to the area and access specified in the attached sketch.
2. Locality
APPROX 140KM NORTH WEST OF CLERMONT
3. Local Authority
for the purpose of: PEGGING
4. Access through
LOT 5091 ON PH1882 LEASEHOLD PASTORAL HOLDING 12/5091
5. Background Land
LOT 5091 ON PH1882 LEASEHOLD PASTORAL HOLDING 12/5091
6. Minerals
COAL
7. Date Grant
01-MAY-2013
8. Date Commence
02-MAY-2013
9. Date Expires
01-AUG-2013
10. Conditions
This Prospecting Permit is subject to the prescribed conditions and such other conditions as are imposed or varied from time to time by notice in writing and signed by the Mining Registrar.
11. Special Circumstances
CONDITIONS AS PRESCRIBED AND ATTACHED : CONSENT IN INCLUDE THE AREA OF MINING LEASE APPLICATION 70490 IN THE PROSPECTING PERMIT LODGED.

Granted this first day of May 2013.

_____ Mining Registrar

CONDITIONS

The holder of the within Prospecting Permit is required to:-

- (a) use, if practicable, only existing roads or tracks on the land to which the permit applies;
- (b) take reasonable steps to ensure no reproductive material of a declared plant is moved onto, within or from the land to which the permit applies. "Declared plant" means a plant that is a declared pest under the *Land Protection (Pest and Stock Route Management) Act 2002* or declared to be a pest under a local law of a local government.
- (c) not allow an animal in the custody of the holder or person to be on the land to which the permit applies unless the land is fenced in a way to prevent the animal from leaving the land or the animal is restrained;
- (d) gain access to occupied land only at a point or points designated by a mining registrar unless the holder has obtained the consent in writing of the owner and has lodged that consent with the mining registrar;
- (e) not discharge a firearm unless the holder has the written consent of the owner of the land and the consent has been lodged with the mining registrar;
- (f) not light an open fire unless the holder has the written consent of the owner of the land and the consent has been lodged with the mining registrar;
- (g) not engage in any form of dredging;
- (h) not enter and be upon the surface of land of an owner within 100 metres laterally of a permanent building used mainly as accommodation, or for business purposes, or for community, sporting or recreational purposes, or as a place of worship, or within 50 metres laterally of a principal stockyard or dam, bore or artesian well or a cemetery or burial place without the written consent of the owner of that land lodged with the mining registrar;
- (i) not enter land within 50m laterally of a place where activities are being carried on under an exploration permit only with the written consent of the exploration permit holder;
- (j) Prior notice of entry to be served. At least 5 business days (or such shorter period as is acceptable to the owner of the land and endorsed on the Notice of Entry) before initial entry is made on land under the authority of a prospecting permit, the holder of the prospecting permit shall notify the owner of intention to enter.
- (k) A holder of a prospecting permit for land may enter the land for-
 - a. purposes necessary to enable the holder to apply for a mining claim or mining lease over the land

The holder may-

- (a) enter and leave the land using a reasonable type of transport; and
- (b) enter and leave the land through land the permit states is access land.

(l) Consent required to enter certain land

1. A parcel prospecting permit holder may enter the surface of a reserve for prospecting purposes only with the written consent of the owner of the reserve.
2. A district prospecting permit holder may enter the surface of occupied land only with the written consent of the owner of the land.
3. Also, a prospecting permit holder may enter occupied land for hand mining only with the written consent of the owner of the land.
4. In addition, a prospecting permit holder may enter restricted land only with the written consent of the owner of the land where the relevant permanent building, or relevant feature, is situated.

Note: Restricted land is defined as follows:

- a) Land within 100 m laterally of a permanent building used –
 - i. mainly as accommodation or for business purposes; or
 - ii. for community, sporting or recreational purposes or as a place of worship.
- b) Land within 50 m laterally of any of the following features –
 - i. a principal stockyard;
 - ii. a bore or artesian well;
 - iii. a dam;
 - iv. another artificial water storage connected to a water supply;
 - v. a cemetery or burial place.

5. Further, a prospecting permit holder may enter land within 50 metres laterally of a place where activities are being carried on under an exploration permit only with the written consent of the exploration permit holder.

- (m) not enter occupied land at night without the written consent of the land owner (you must comply with the owners conditions) OR unless the mining registrar permits entry at night (you must abide by the mining registrars conditions)
- (n) comply with the Code of Environmental Compliance for prospecting permits for purposes of hand mining.

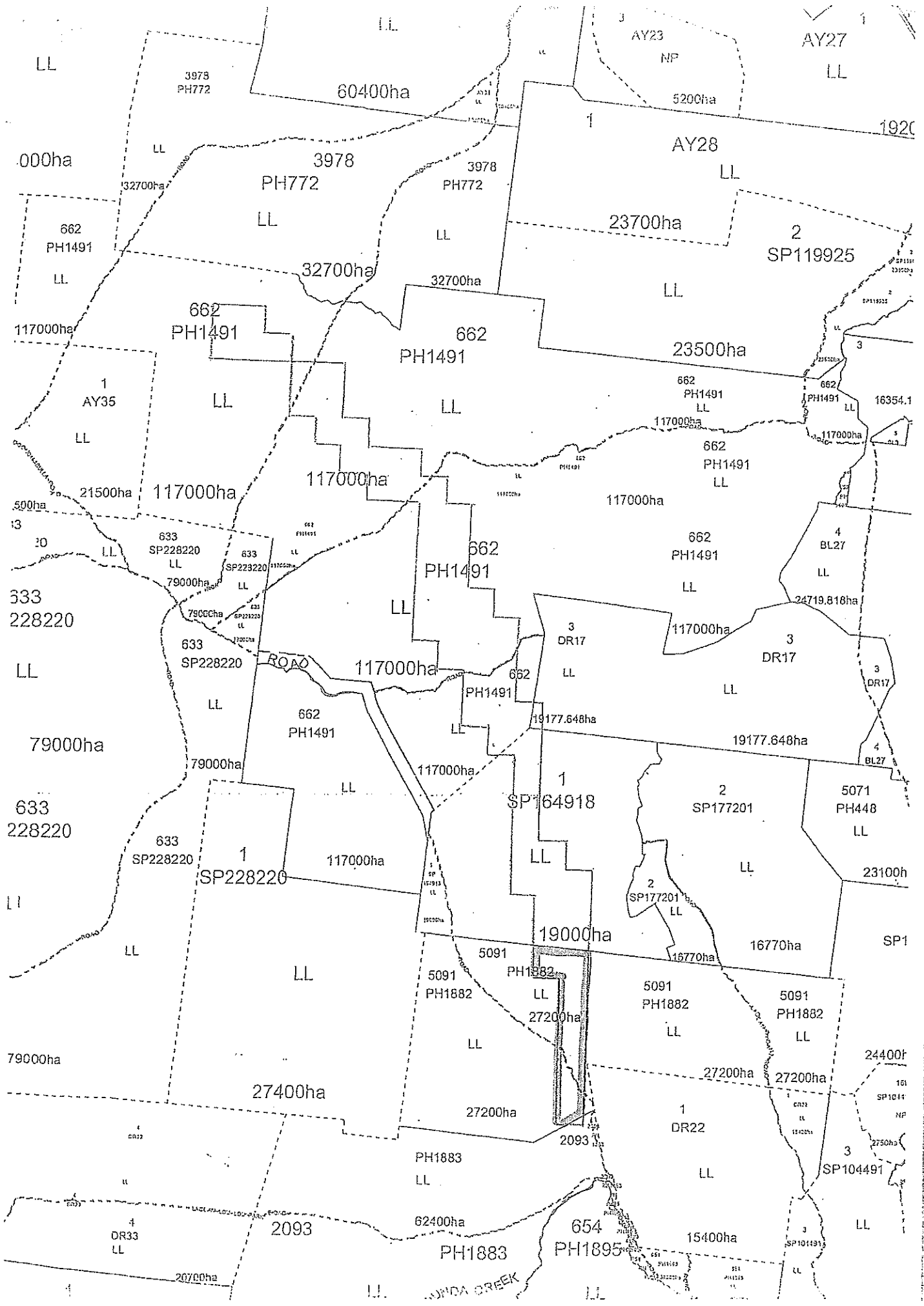

LOT 5091 ON PH 1882



Part 3
Form Number 3

QUEENSLAND
MINERAL RESOURCES ACT 1989

PARCEL PROSPECTING PERMIT NO 74037

MINING DISTRICT : EMERALD

1. Full name and address of holder
ADANI MINING PTY LTD
C/- MINING TENEMENT SERVICES
GPO BOX 215
BRISBANE
QLD
4001

the holder of this Prospecting Permit and persons so authorised under the Mineral Resources Act 1989 by the issue of this Permit are permitted to enter upon the land described hereunder but restricted to the area and access specified in the attached sketch.

2. Locality APPROX 140KM NORTH WEST OF CLERMONT

3. Local Authority Isaac (R)

for the purpose of: PEGGING

4. Access through LOT 662 ON PH1491 LEASEHOLD PASTORAL HOLDING 12/662

5. Background Land LOT 662 ON PH1491 LEASEHOLD PASTORAL HOLDING 12/662

6. Minerals COAL

7. Date Grant 01-MAY-2013

8. Date Commence 02-MAY-2013

9. Date Expires 01-AUG-2013

10. Conditions *This Prospecting Permit is subject to the prescribed conditions and such other conditions as are imposed or varied from time to time by notice in writing and signed by the Mining Registrar.*

11. Special Circumstances CONDITIONS AS PRESCRIBED AND ATTACHED : CONSENT INCLUDE THE AREA OF MINING LEASE APPLICATIONS 70487 AND MLA 70490 IN THE PROSPECTING PERMIT LODGED.

Granted this first day of May 2013.

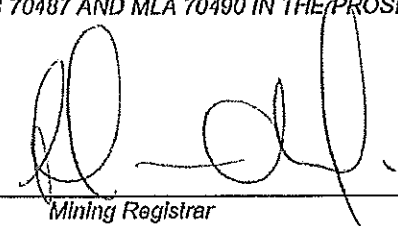
Mining Registrar

CONDITIONS

The holder of the within Prospecting Permit is required to:-

- (a) use, if practicable, only existing roads or tracks on the land to which the permit applies;
- (b) take reasonable steps to ensure no reproductive material of a declared plant is moved onto, within or from the land to which the permit applies. "Declared plant" means a plant that is a declared pest under the *Land Protection (Pest and Stock Route Management) Act 2002* or declared to be a pest under a local law of a local government.
- (c) not allow an animal in the custody of the holder or person to be on the land to which the permit applies unless the land is fenced in a way to prevent the animal from leaving the land or the animal is restrained;
- (d) gain access to occupied land only at a point or points designated by a mining registrar unless the holder has obtained the consent in writing of the owner and has lodged that consent with the mining registrar;
- (e) not discharge a firearm unless the holder has the written consent of the owner of the land and the consent has been lodged with the mining registrar;
- (f) not light an open fire unless the holder has the written consent of the owner of the land and the consent has been lodged with the mining registrar;
- (g) not engage in any form of dredging;
- (h) not enter and be upon the surface of land of an owner within 100 metres laterally of a permanent building used mainly as accommodation, or for business purposes, or for community, sporting or recreational purposes, or as a place of worship, or within 50 metres laterally of a principal stockyard or dam, bore or artesian well or a cemetery or burial place without the written consent of the owner of that land lodged with the mining registrar;
- (i) not enter land within 50m laterally of a place where activities are being carried on under an exploration permit only with the written consent of the exploration permit holder;
- (j) Prior notice of entry to be served. At least 5 business days (or such shorter period as is acceptable to the owner of the land and endorsed on the Notice of Entry) before initial entry is made on land under the authority of a prospecting permit, the holder of the prospecting permit shall notify the owner of intention to enter.
- (k) A holder of a prospecting permit for land may enter the land for-
 - a. purposes necessary to enable the holder to apply for a mining claim or mining lease over the land

The holder may-

- (a) enter and leave the land using a reasonable type of transport; and
- (b) enter and leave the land through land the permit states is access land.

(l) Consent required to enter certain land

1. A parcel prospecting permit holder may enter the surface of a reserve for prospecting purposes only with the written consent of the owner of the reserve.
2. A district prospecting permit holder may enter the surface of occupied land only with the written consent of the owner of the land.
3. Also, a prospecting permit holder may enter occupied land for hand mining only with the written consent of the owner of the land.
4. In addition, a prospecting permit holder may enter restricted land only with the written consent of the owner of the land where the relevant permanent building, or relevant feature, is situated.

Note: Restricted land is defined as follows:

- a) Land within 100 m laterally of a permanent building used –
 - i. mainly as accommodation or for business purposes; or
 - ii. for community, sporting or recreational purposes or as a place of worship.
- b) Land within 50 m laterally of any of the following features –
 - i. a principal stockyard;
 - ii. a bore or artesian well;
 - iii. a dam;
 - iv. another artificial water storage connected to a water supply;
 - v. a cemetery or burial place.

5. Further, a prospecting permit holder may enter land within 50 metres laterally of a place where activities are being carried on under an exploration permit only with the written consent of the exploration permit holder.

- (m) not enter occupied land at night without the written consent of the land owner (you must comply with the owners conditions) OR unless the mining registrar permits entry at night (you must abide by the mining registrars conditions)
- (n) comply with the Code of Environmental Compliance for prospecting permits for purposes of hand mining.

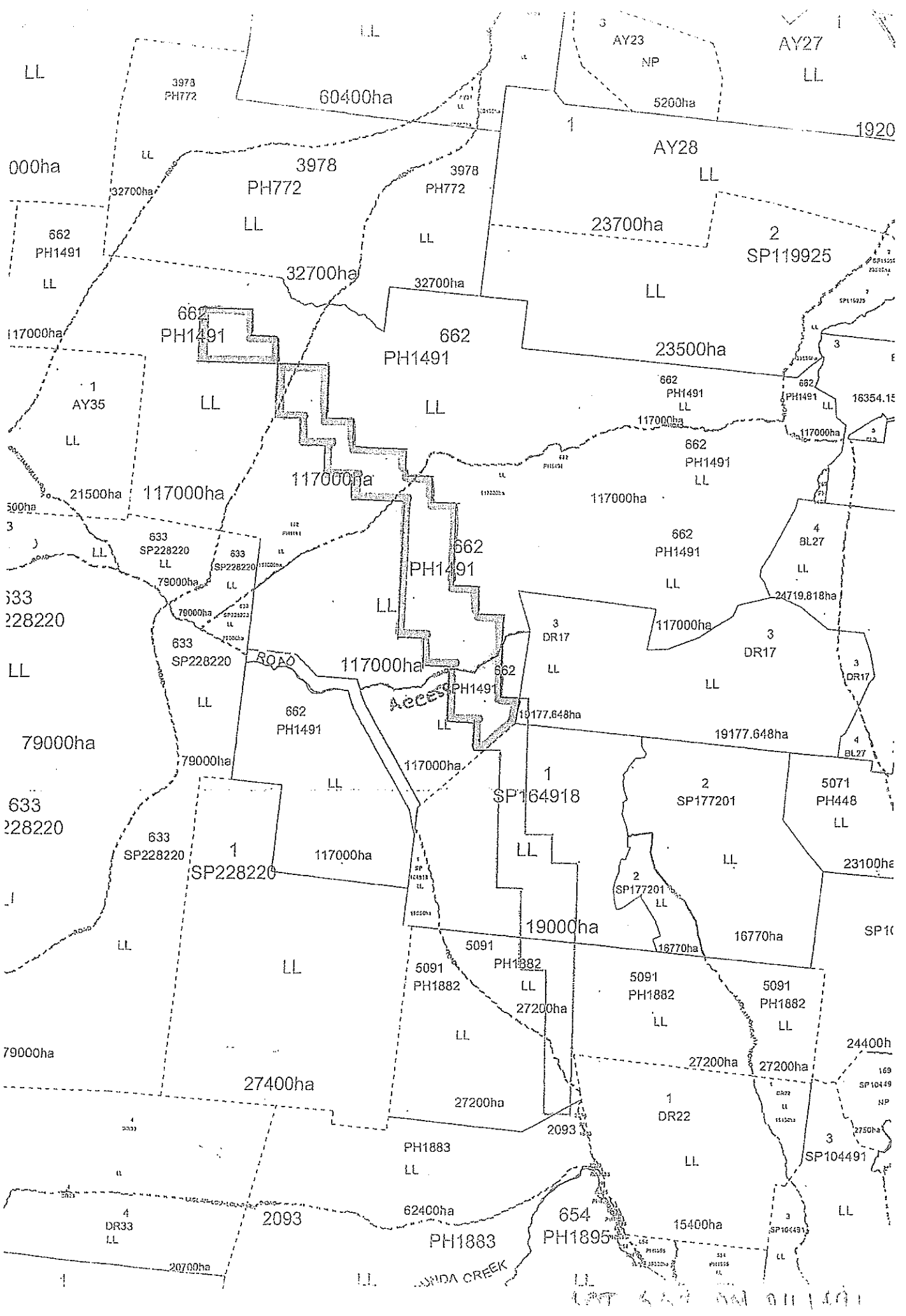

LOT 649 ON 011401



Part 3
Form Number 3

QUEENSLAND
MINERAL RESOURCES ACT 1989

PARCEL PROSPECTING PERMIT NO 74038

MINING DISTRICT : EMERALD

1. Full name and address of holder ADANI MINING PTY LTD
C/- MINING TENEMENT SERVICES
GPO BOX 215
BRISBANE
QLD
4001
the holder of this Prospecting Permit and persons so authorised under the Mineral Resources Act 1989 by the issue of this Permit are permitted to enter upon the land described hereunder but restricted to the area and access specified in the attached sketch.
2. Locality APPROX 140KM NORTH WEST OF CLERMONT
3. Local Authority Isaac (R)
for the purpose of: PEGGING
4. Access through LOT 1 ON SP164018 LEASEHOLD GRAZING HOMESTEAD PERPETUAL LEASE 220168
5. Background Land LOT 1 ON SP164018 LEASEHOLD GRAZING HOMESTEAD PERPETUAL LEASE 220168
6. Minerals COAL
7. Date Grant 01-MAY-2013
8. Date Commence 02-MAY-2013
9. Date Expires 01-AUG-2013
10. Conditions *This Prospecting Permit is subject to the prescribed conditions and such other conditions as are imposed or varied from time to time by notice in writing and signed by the Mining Registrar.*
11. Special Circumstances CONDITIONS AS PRESCRIBED AND ATTACHED : CONSENT TO INCLUDE THE AREA OF MINING LEASE APPLICATION 70490 IN THE PROSPECTING PERMIT LODGED.

Granted this first day of May 2013.

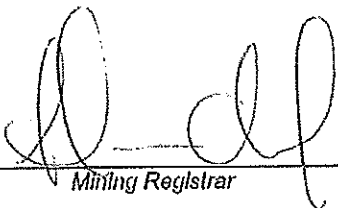
Mining Registrar

CONDITIONS

The holder of the within Prospecting Permit is required to:-

- (a) use, if practicable, only existing roads or tracks on the land to which the permit applies;
- (b) take reasonable steps to ensure no reproductive material of a declared plant is moved onto, within or from the land to which the permit applies. "Declared plant" means a plant that is a declared pest under the *Land Protection (Pest and Stock Route Management) Act 2002* or declared to be a pest under a local law of a local government.
- (c) not allow an animal in the custody of the holder or person to be on the land to which the permit applies unless the land is fenced in a way to prevent the animal from leaving the land or the animal is restrained;
- (d) gain access to occupied land only at a point or points designated by a mining registrar unless the holder has obtained the consent in writing of the owner and has lodged that consent with the mining registrar;
- (e) not discharge a firearm unless the holder has the written consent of the owner of the land and the consent has been lodged with the mining registrar;
- (f) not light an open fire unless the holder has the written consent of the owner of the land and the consent has been lodged with the mining registrar;
- (g) not engage in any form of dredging;
- (h) not enter and be upon the surface of land of an owner within 100 metres laterally of a permanent building used mainly as accommodation, or for business purposes, or for community, sporting or recreational purposes, or as a place of worship, or within 50 metres laterally of a principal stockyard or dam, bore or artesian well or a cemetery or burial place without the written consent of the owner of that land lodged with the mining registrar;
- (i) not enter land within 50m laterally of a place where activities are being carried on under an exploration permit only with the written consent of the exploration permit holder;
- (j) Prior notice of entry to be served. At least 5 business days (or such shorter period as is acceptable to the owner of the land and endorsed on the Notice of Entry) before initial entry is made on land under the authority of a prospecting permit, the holder of the prospecting permit shall notify the owner of intention to enter.
- (k) A holder of a prospecting permit for land may enter the land for-
 - a. purposes necessary to enable the holder to apply for a mining claim or mining lease over the land

The holder may-

- (a) enter and leave the land using a reasonable type of transport; and
- (b) enter and leave the land through land the permit states is access land.

(l) Consent required to enter certain land

1. A parcel prospecting permit holder may enter the surface of a reserve for prospecting purposes only with the written consent of the owner of the reserve.
2. A district prospecting permit holder may enter the surface of occupied land only with the written consent of the owner of the land.
3. Also, a prospecting permit holder may enter occupied land for hand mining only with the written consent of the owner of the land.
4. In addition, a prospecting permit holder may enter restricted land only with the written consent of the owner of the land where the relevant permanent building, or relevant feature, is situated.

Note: Restricted land is defined as follows:

- a) Land within 100 m laterally of a permanent building used –
 - i. mainly as accommodation or for business purposes; or
 - ii. for community, sporting or recreational purposes or as a place of worship.
- b) Land within 50 m laterally of any of the following features –
 - i. a principal stockyard;
 - ii. a bore or artesian well;
 - iii. a dam;
 - iv. another artificial water storage connected to a water supply;
 - v. a cemetery or burial place.

5. Further, a prospecting permit holder may enter land within 50 metres laterally of a place where activities are being carried on under an exploration permit only with the written consent of the exploration permit holder.

(m) not enter occupied land at night without the written consent of the land owner (you must comply with the owners conditions) OR unless the mining registrar permits entry at night (you must abide by the mining registrars conditions)

(n) comply with the Code of Environmental Compliance for prospecting permits for purposes of hand mining.

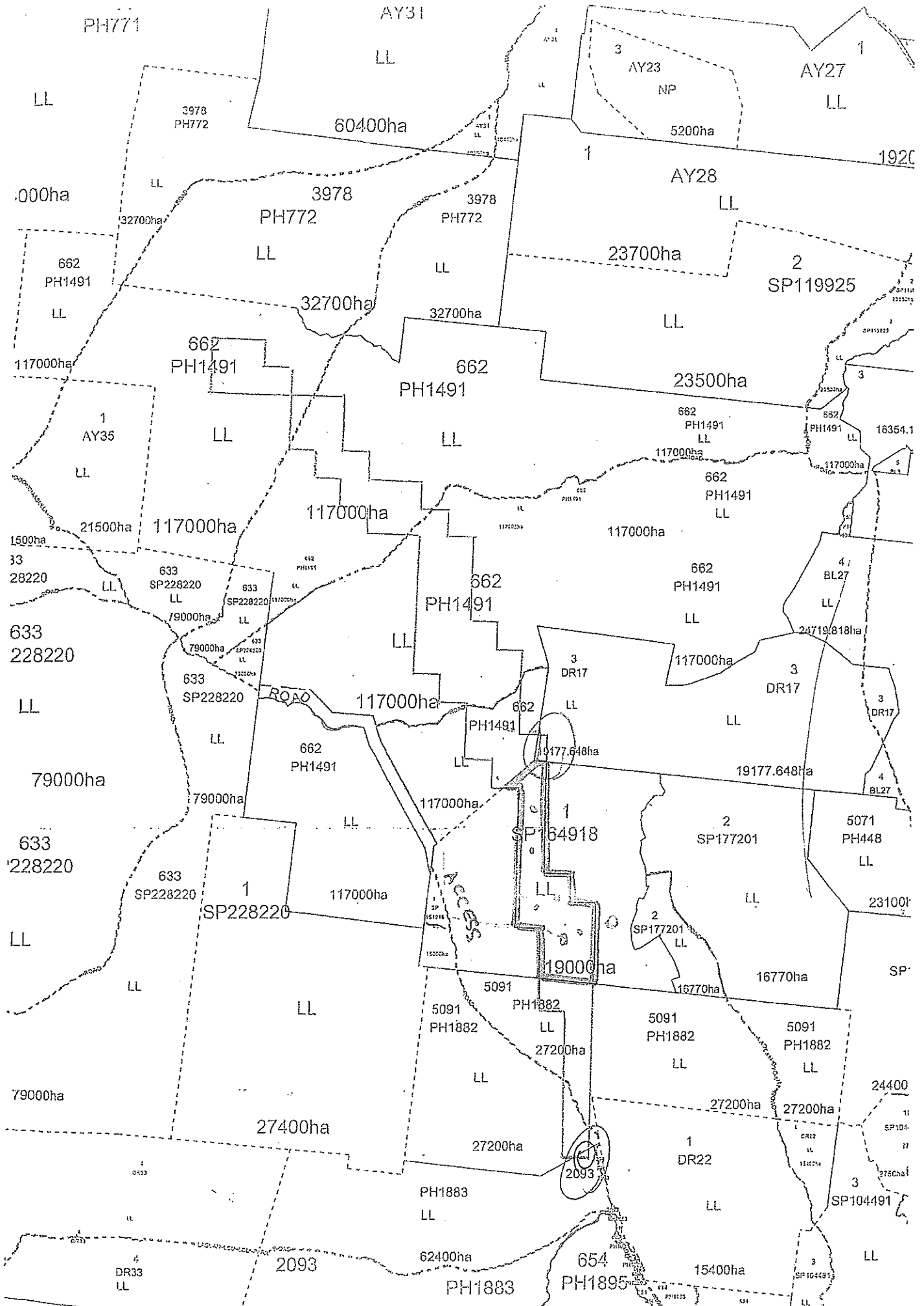

LOTT ON SP 164918



Part 3
Form Number 3

QUEENSLAND
MINERAL RESOURCES ACT 1989

PARCEL PROSPECTING PERMIT NO 74039

MINING DISTRICT : EMERALD

1. Full name and address of holder ADANI MINING PTY LTD
C/- MINING TENEMENT SERVICES
GPO BOX 215
BRISBANE
QLD
4001
the holder of this Prospecting Permit and persons so authorised under the Mineral Resources Act 1989 by the issue of this Permit are permitted to enter upon the land described hereunder but restricted to the area and access specified in the attached sketch.
2. Locality APPROX 140KM NORTH WEST OF CLERMONT
3. Local Authority Isaac (R)
for the purpose of: PEGGING
4. Access through
5. Background Land ROAD RESERVE UNNAMED ROAD WITHIN LOT 5091 ON PH1882 PASTORAL HOLDING
6. Minerals COAL
7. Date Grant 01-MAY-2013
8. Date Commence 02-MAY-2013
9. Date Expires 01-AUG-2013
10. Conditions *This Prospecting Permit is subject to the prescribed conditions and such other conditions as are imposed or varied from time to time by notice in writing and signed by the Mining Registrar.*
11. Special Circumstances CONDITIONS AS PRESCRIBED AND ATTACHED : PERMIT RESTRICTED THAT PART OF ROAD RESERVE AS SHOWN ON THE ATTACHED PLAN - CONSENT TO INCLUDE AREA OF MINING LEASE APPLICATION 70490 IN THE PROSPECTING PERMIT LODGED.

Granted this first day of May 2013.

A handwritten signature in black ink, consisting of several loops and a long horizontal stroke, positioned above a horizontal line.

Mining Registrar

CONDITIONS

The holder of the within Prospecting Permit is required to:-

- (a) use, if practicable, only existing roads or tracks on the land to which the permit applies;
- (b) take reasonable steps to ensure no reproductive material of a declared plant is moved onto, within or from the land to which the permit applies. "Declared plant" means a plant that is a declared pest under the *Land Protection (Pest and Stock Route Management) Act 2002* or declared to be a pest under a local law of a local government.
- (c) not allow an animal in the custody of the holder or person to be on the land to which the permit applies unless the land is fenced in a way to prevent the animal from leaving the land or the animal is restrained;
- (d) gain access to occupied land only at a point or points designated by a mining registrar unless the holder has obtained the consent in writing of the owner and has lodged that consent with the mining registrar;
- (e) not discharge a firearm unless the holder has the written consent of the owner of the land and the consent has been lodged with the mining registrar;
- (f) not light an open fire unless the holder has the written consent of the owner of the land and the consent has been lodged with the mining registrar;
- (g) not engage in any form of dredging;
- (h) not enter and be upon the surface of land of an owner within 100 metres laterally of a permanent building used mainly as accommodation, or for business purposes, or for community, sporting or recreational purposes, or as a place of worship, or within 50 metres laterally of a principal stockyard or dam, bore or artesian well or a cemetery or burial place without the written consent of the owner of that land lodged with the mining registrar;
- (i) not enter land within 50m laterally of a place where activities are being carried on under an exploration permit only with the written consent of the exploration permit holder;
- (j) Prior notice of entry to be served. At least 5 business days (or such shorter period as is acceptable to the owner of the land and endorsed on the Notice of Entry) before initial entry is made on land under the authority of a prospecting permit, the holder of the prospecting permit shall notify the owner of intention to enter.
- (k) A holder of a prospecting permit for land may enter the land for-
 - a. purposes necessary to enable the holder to apply for a mining claim or mining lease over the land

The holder may-

- (a) enter and leave the land using a reasonable type of transport; and
- (b) enter and leave the land through land the permit states is access land.

(l) Consent required to enter certain land

1. A parcel prospecting permit holder may enter the surface of a reserve for prospecting purposes only with the written consent of the owner of the reserve.
2. A district prospecting permit holder may enter the surface of occupied land only with the written consent of the owner of the land.
3. Also, a prospecting permit holder may enter occupied land for hand mining only with the written consent of the owner of the land.
4. In addition, a prospecting permit holder may enter restricted land only with the written consent of the owner of the land where the relevant permanent building, or relevant feature, is situated.

Note: Restricted land is defined as follows:

- a) Land within 100 m laterally of a permanent building used –
 - i. mainly as accommodation or for business purposes; or
 - ii. for community, sporting or recreational purposes or as a place of worship.
- b) Land within 50 m laterally of any of the following features –
 - i. a principal stockyard;
 - ii. a bore or artesian well;
 - iii. a dam;
 - iv. another artificial water storage connected to a water supply;
 - v. a cemetery or burial place.

5. Further, a prospecting permit holder may enter land within 50 metres laterally of a place where activities are being carried on under an exploration permit only with the written consent of the exploration permit holder.

(m) not enter occupied land at night without the written consent of the land owner (you must comply with the owners conditions) OR unless the mining registrar permits entry at night (you must abide by the mining registrars conditions)

(n) comply with the Code of Environmental Compliance for prospecting permits for purposes of hand mining.

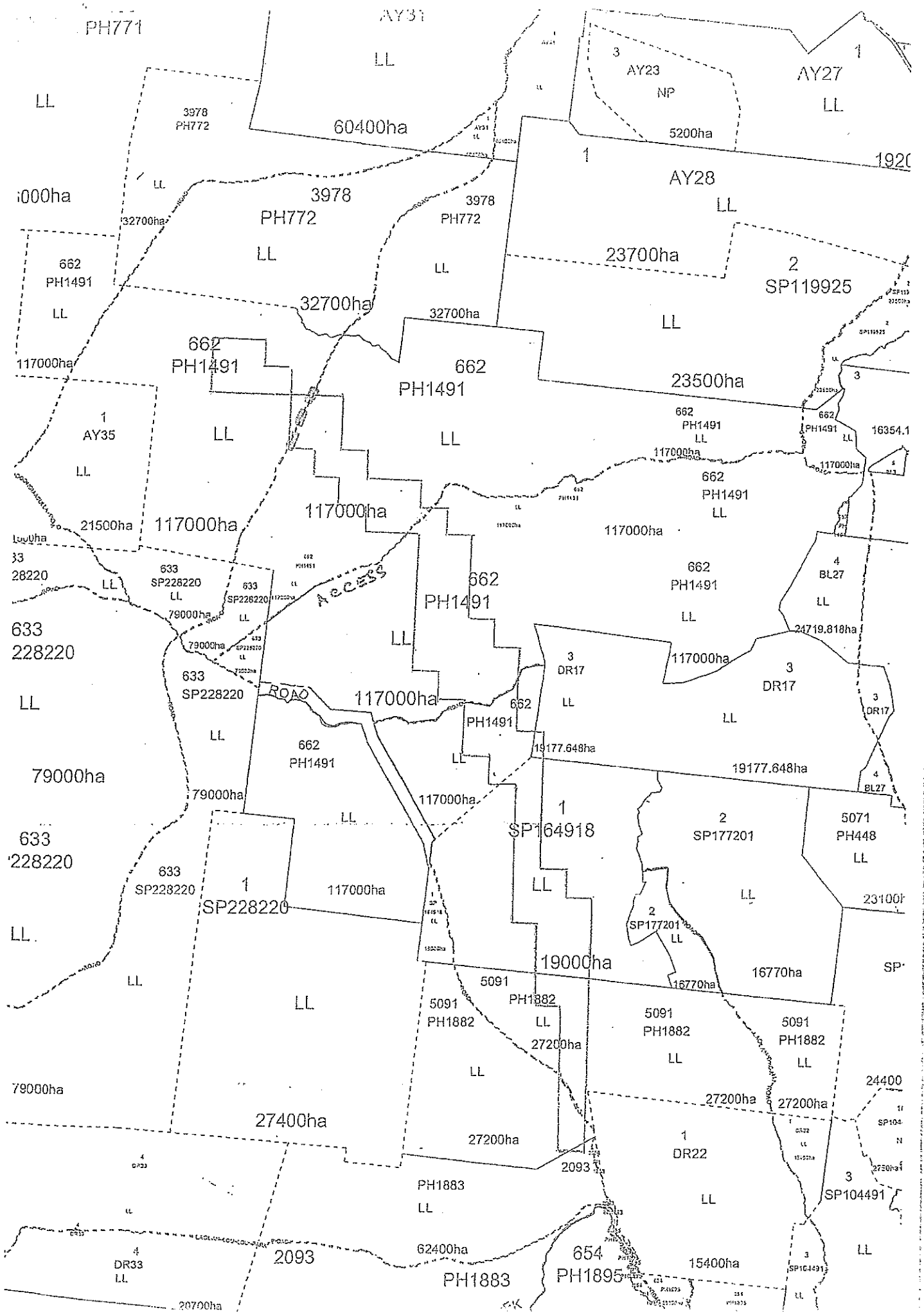

ROAD RESERVE IN LOT 664 ON PH 1491



Part 3
Form Number 3

QUEENSLAND
MINERAL RESOURCES ACT 1989

PARCEL PROSPECTING PERMIT NO 74040

MINING DISTRICT : EMERALD

1. Full name and address of holder ADANI MINING PTY LTD
C/- MINING TENEMENT SERVICES
GPO BOX 215
BRISBANE
QLD
4001
the holder of this Prospecting Permit and persons so authorised under the Mineral Resources Act 1989 by the issue of this Permit are permitted to enter upon the land described hereunder but restricted to the area and access specified in the attached sketch.
2. Locality APPROX 140 KM NORTH WEST OF CLERMONT
3. Local Authority Isaac (R)
for the purpose of: PEGGING
4. Access through
5. Background Land ROAD RESERVE UNNAMED ROAD WITHIN LOT 662 ON PH1491
6. Minerals COAL
7. Date Grant 01-MAY-2013
8. Date Commence 02-MAY-2013
9. Date Expires 01-AUG-2013
10. Conditions *This Prospecting Permit is subject to the prescribed conditions and such other conditions as are imposed or varied from time to time by notice in writing and signed by the Mining Registrar.*
11. Special Circumstances *CONDITIONS AS PRESCRIBED AND ATTACHED. PERMIT RESTRICTED THAT PART OF ROAD RESERVE HAS SHOWN ON ATTACHED PLAN. CONSENT FOR THE INCLUSION OF LAND WITHIN MINING LEASE APPLICATION 70490 LODGED WITH APPLICATION.*

Granted this first day of May 2013.

A handwritten signature in black ink, appearing to be "D. J. ...", written over a horizontal line.

Mining Registrar

CONDITIONS

The holder of the within Prospecting Permit is required to:-

- (a) use, if practicable, only existing roads or tracks on the land to which the permit applies;
- (b) take reasonable steps to ensure no reproductive material of a declared plant is moved onto, within or from the land to which the permit applies. "Declared plant" means a plant that is a declared pest under the *Land Protection (Pest and Stock Route Management) Act 2002* or declared to be a pest under a local law of a local government.
- (c) not allow an animal in the custody of the holder or person to be on the land to which the permit applies unless the land is fenced in a way to prevent the animal from leaving the land or the animal is restrained;
- (d) gain access to occupied land only at a point or points designated by a mining registrar unless the holder has obtained the consent in writing of the owner and has lodged that consent with the mining registrar;
- (e) not discharge a firearm unless the holder has the written consent of the owner of the land and the consent has been lodged with the mining registrar;
- (f) not light an open fire unless the holder has the written consent of the owner of the land and the consent has been lodged with the mining registrar;
- (g) not engage in any form of dredging;
- (h) not enter and be upon the surface of land of an owner within 100 metres laterally of a permanent building used mainly as accommodation, or for business purposes, or for community, sporting or recreational purposes, or as a place of worship, or within 50 metres laterally of a principal stockyard or dam, bore or artesian well or a cemetery or burial place without the written consent of the owner of that land lodged with the mining registrar;
- (i) not enter land within 50m laterally of a place where activities are being carried on under an exploration permit only with the written consent of the exploration permit holder;
- (j) Prior notice of entry to be served. At least 5 business days (or such shorter period as is acceptable to the owner of the land and endorsed on the Notice of Entry) before initial entry is made on land under the authority of a prospecting permit, the holder of the prospecting permit shall notify the owner of intention to enter.
- (k) A holder of a prospecting permit for land may enter the land for-
 - a. purposes necessary to enable the holder to apply for a mining claim or mining lease over the land

The holder may-

- (a) enter and leave the land using a reasonable type of transport; and
- (b) enter and leave the land through land the permit states is access land.

(l) Consent required to enter certain land

1. A parcel prospecting permit holder may enter the surface of a reserve for prospecting purposes only with the written consent of the owner of the reserve.
2. A district prospecting permit holder may enter the surface of occupied land only with the written consent of the owner of the land.
3. Also, a prospecting permit holder may enter occupied land for hand mining only with the written consent of the owner of the land.
4. In addition, a prospecting permit holder may enter restricted land only with the written consent of the owner of the land where the relevant permanent building, or relevant feature, is situated.

Note: Restricted land is defined as follows:

- a) Land within 100 m laterally of a permanent building used –
 - i. mainly as accommodation or for business purposes; or
 - ii. for community, sporting or recreational purposes or as a place of worship.
- b) Land within 50 m laterally of any of the following features –
 - i. a principal stockyard;
 - ii. a bore or artesian well;
 - iii. a dam;
 - iv. another artificial water storage connected to a water supply;
 - v. a cemetery or burial place.

5. Further, a prospecting permit holder may enter land within 50 metres laterally of a place where activities are being carried on under an exploration permit only with the written consent of the exploration permit holder.

(m) not enter occupied land at night without the written consent of the land owner (you must comply with the owners conditions) OR unless the mining registrar permits entry at night (you must abide by the mining registrars conditions)

(n) comply with the Code of Environmental Compliance for prospecting permits for purposes of hand mining.

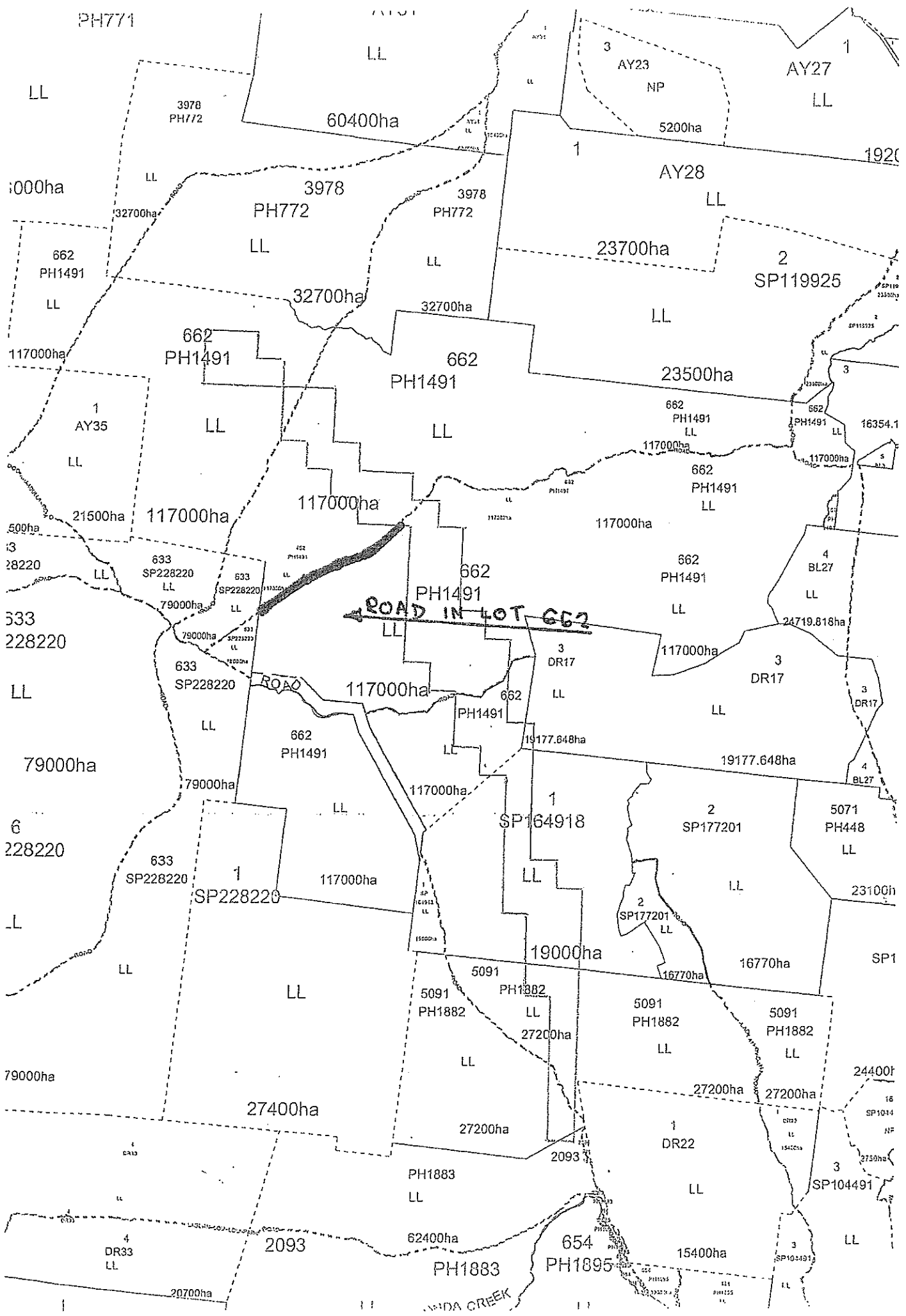

ROAD IN LOT 662

WANDA CREEK

PH771

60400ha

AY23

AY27

AY28

3978
PH772

3978
PH772

3978
PH772

23700ha

2
SP119925

662
PH1491

32700ha

32700ha

23500ha

662
PH1491

662
PH1491

117000ha

662
PH1491

16354.1

1
AY35

117000ha

117000ha

117000ha

662
PH1491

662
PH1491

4
BL27

500ha

633
SP228220

633
SP228220

662
PH1491

662
PH1491

24719.818ha

333
228220

633
SP228220

ROAD

117000ha

3
DR17

117000ha

3
DR17

3
DR17

LL

LL

LL

662
PH1491

662
PH1491

19177.648ha

LL

19177.648ha

4
BL27

79000ha

79000ha

117000ha

117000ha

1
SP164918

2
SP177201

5071
PH448

23100h

6
228220

633
SP228220

1
SP228220

117000ha

LL

2
SP177201

LL

SP1

LL

LL

LL

19000ha

16770ha

16770ha

SP1

79000ha

27400ha

27200ha

5091
PH1882

5091
PH1882

5091
PH1882

24400h

LL

PH1883
LL

1
DR22

LL

3
SP104491

4
DR33
LL

2093

62400ha

PH1883

654
PH1895

15400ha

3
SP104491

20700ha

LL

LL

LL

LL



Part 3
Form Number 3

QUEENSLAND
MINERAL RESOURCES ACT 1989

PARCEL PROSPECTING PERMIT NO 74041

MINING DISTRICT : EMERALD

1. Full name and address of holder ADANI MINING PTY LTD
C/- MINING TENEMENT SERVICES
GPO BOX 215
BRISBANE
QLD
4001
the holder of this Prospecting Permit and persons so authorised under the Mineral Resources Act 1989 by the issue of this Permit are permitted to enter upon the land described hereunder but restricted to the area and access specified in the attached sketch.
2. Locality APPROX 140 KM NORTH WEST OF CLERMONT
3. Local Authority Isaac (R)
for the purpose of: PEGGING
4. Access through
5. Background Land ROAD RESERVE UNNAMED ROAD WITHIN LOT 662 ON PH1491
6. Minerals COAL
7. Date Grant 01-MAY-2013
8. Date Commence 02-MAY-2013
9. Date Expires 01-AUG-2013
10. Conditions *This Prospecting Permit is subject to the prescribed conditions and such other conditions as are imposed or varied from time to time by notice in writing and signed by the Mining Registrar.*
11. Special Circumstances CONDITIONS AS ATTACHED AND PRESCRIBED. PERMIT RESTRICTED TO THAT PART OF THE ROAD RESERVE AS SHOWN ON ATTACHED PLAN. CONSENT TO INCLUDE LAND WITHIN MINING LEASE APPLICATION 70490 LODGED.

Granted this first day of May 2013.

A handwritten signature in black ink, appearing to be "S. J. O'Connell", written over a horizontal line.

Mining Registrar

CONDITIONS

The holder of the within Prospecting Permit is required to:-

- (a) use, if practicable, only existing roads or tracks on the land to which the permit applies;
- (b) take reasonable steps to ensure no reproductive material of a declared plant is moved onto, within or from the land to which the permit applies. "Declared plant" means a plant that is a declared pest under the *Land Protection (Pest and Stock Route Management) Act 2002* or declared to be a pest under a local law of a local government.
- (c) not allow an animal in the custody of the holder or person to be on the land to which the permit applies unless the land is fenced in a way to prevent the animal from leaving the land or the animal is restrained;
- (d) gain access to occupied land only at a point or points designated by a mining registrar unless the holder has obtained the consent in writing of the owner and has lodged that consent with the mining registrar;
- (e) not discharge a firearm unless the holder has the written consent of the owner of the land and the consent has been lodged with the mining registrar;
- (f) not light an open fire unless the holder has the written consent of the owner of the land and the consent has been lodged with the mining registrar;
- (g) not engage in any form of dredging;
- (h) not enter and be upon the surface of land of an owner within 100 metres laterally of a permanent building used mainly as accommodation, or for business purposes, or for community, sporting or recreational purposes, or as a place of worship, or within 50 metres laterally of a principal stockyard or dam, bore or artesian well or a cemetery or burial place without the written consent of the owner of that land lodged with the mining registrar;
- (i) not enter land within 50m laterally of a place where activities are being carried on under an exploration permit only with the written consent of the exploration permit holder;
- (j) Prior notice of entry to be served. At least 5 business days (or such shorter period as is acceptable to the owner of the land and endorsed on the Notice of Entry) before initial entry is made on land under the authority of a prospecting permit, the holder of the prospecting permit shall notify the owner of intention to enter.
- (k) A holder of a prospecting permit for land may enter the land for-
 - a. purposes necessary to enable the holder to apply for a mining claim or mining lease over the land

The holder may-

- (a) enter and leave the land using a reasonable type of transport; and
- (b) enter and leave the land through land the permit states is access land.

(l) Consent required to enter certain land

1. A parcel prospecting permit holder may enter the surface of a reserve for prospecting purposes only with the written consent of the owner of the reserve.
2. A district prospecting permit holder may enter the surface of occupied land only with the written consent of the owner of the land.
3. Also, a prospecting permit holder may enter occupied land for hand mining only with the written consent of the owner of the land.
4. In addition, a prospecting permit holder may enter restricted land only with the written consent of the owner of the land where the relevant permanent building, or relevant feature, is situated.

Note: Restricted land is defined as follows:

- a) Land within 100 m laterally of a permanent building used –
 - i. mainly as accommodation or for business purposes; or
 - ii. for community, sporting or recreational purposes or as a place of worship.
- b) Land within 50 m laterally of any of the following features –
 - i. a principal stockyard;
 - ii. a bore or artesian well;
 - iii. a dam;
 - iv. another artificial water storage connected to a water supply;
 - v. a cemetery or burial place.

5. Further, a prospecting permit holder may enter land within 50 metres laterally of a place where activities are being carried on under an exploration permit only with the written consent of the exploration permit holder.

(m) not enter occupied land at night without the written consent of the land owner (you must comply with the owners conditions) OR unless the mining registrar permits entry at night (you must abide by the mining registrars conditions)

(n) comply with the Code of Environmental Compliance for prospecting permits for purposes of hand mining.

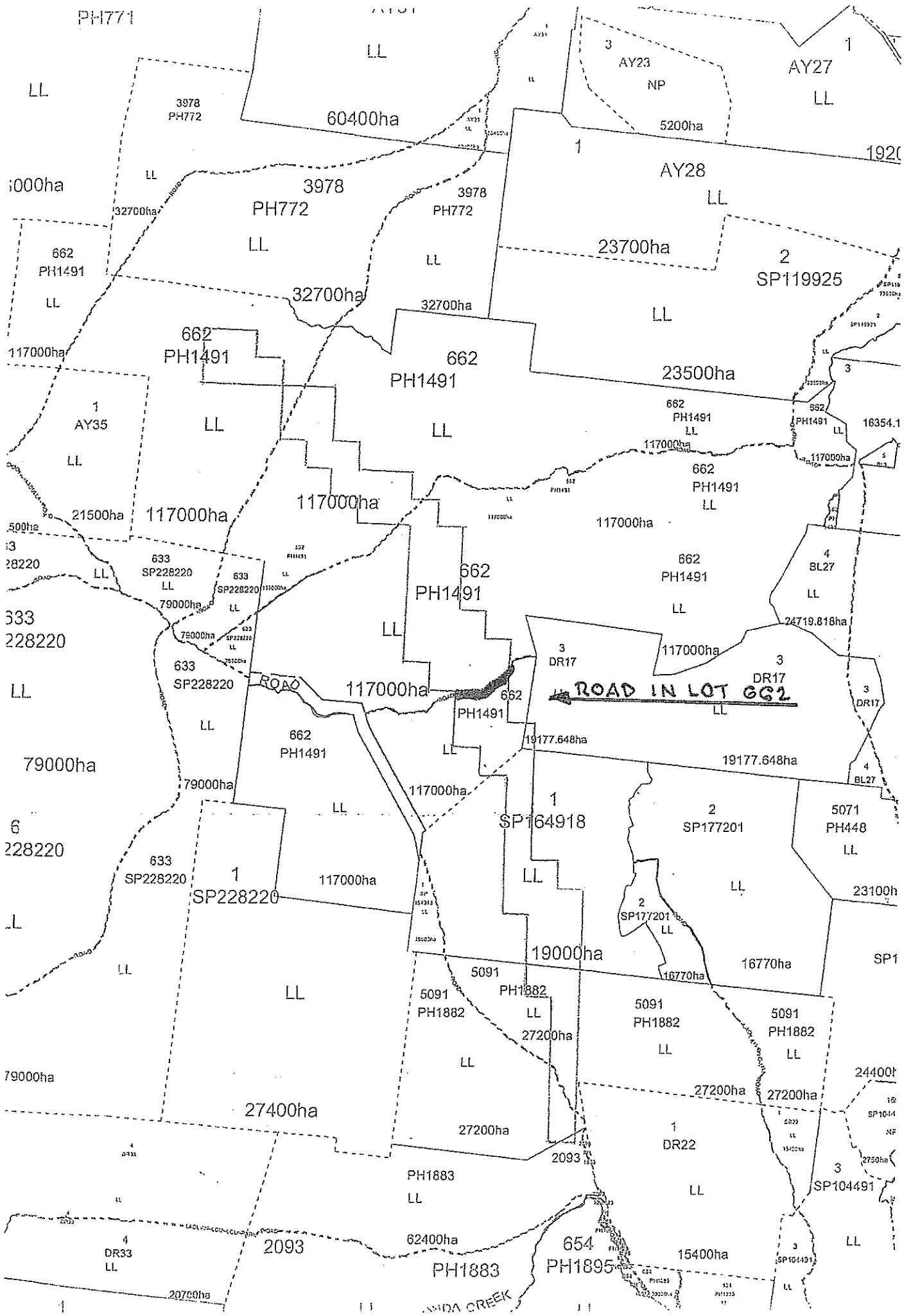

PH771

LL

AY23

AY27

LL

3978
PH772

60400ha

5200ha

1920

10000ha

LL

3978

3978
PH772

AY28

LL

23700ha

2
SP119925

662
PH1491

LL

32700ha

LL

32700ha

LL

23500ha

3

117000ha

662
PH1491

LL

662
PH1491

LL

662
PH1491

662
PH1491

16354.1

1
AY35

117000ha

117000ha

117000ha

117000ha

662
PH1491

662
PH1491

117000ha

500ha

21500ha

LL

633
SP228220

633
SP228220

79000ha

662
PH1491

662
PH1491

4
BL27

24719.818ha

533

228220

633
SP228220

633
SP228220

117000ha

662
PH1491

ROAD IN LOT 662

662
PH1491

117000ha

19177.648ha

3
DR17

LL

79000ha

LL

662
PH1491

LL

19177.648ha

19177.648ha

4
BL27

79000ha

79000ha

LL

117000ha

1
SP164918

2
SP177201

5071
PH448

6

228220

633
SP228220

1
SP228220

117000ha

LL

LL

23100h

LL

LL

LL

19000ha

16770ha

16770ha

SP1

79000ha

5091
PH1882

5091
PH1882

5091
PH1882

5091
PH1882

27400ha

27200ha

27200ha

27200ha

27200ha

24400h

4
DR33

2093

PH1883
LL

2093

1
DR22

3
SP104491

79000ha

62400ha

PH1883

654
PH1895

15400ha

LL

20700ha

WANDA CREEK



Part 3
Form Number 3

QUEENSLAND
MINERAL RESOURCES ACT 1989

PARCEL PROSPECTING PERMIT NO 74042

MINING DISTRICT : EMERALD

1. Full name and address of holder ADANI MINING PTY LTD
C/- MINING TENEMENT SERVICES
GPO BOX 215
BRISBANE
QLD
4001
the holder of this Prospecting Permit and persons so authorised under the Mineral Resources Act 1989 by the issue of this Permit are permitted to enter upon the land described hereunder but restricted to the area and access specified in the attached sketch.
2. Locality APPROX 140 KM NORTH WEST OF CLERMONT
3. Local Authority Aurukun (S)
for the purpose of: PEGGING
4. Access through
5. Background Land ROAD RESERVE UNNAMED ROAD WITHIN LOT 662 ON PH1491
6. Minerals COAL
7. Date Grant 01-MAY-2013
8. Date Commence 02-MAY-2013
9. Date Expires 01-AUG-2013
10. Conditions *This Prospecting Permit is subject to the prescribed conditions and such other conditions as are imposed or varied from time to time by notice in writing and signed by the Mining Registrar.*
11. Special Circumstances CONDITIONS AS ATTACHED AND PRESCRIBED. PERMIT RESTRICTED TO THAT PART OF THE ROAD RESERVE HAS SHOWN ON THE ATTACHED PLAN. CONSENT TO INCLUDE LAND WITHIN MINING LEASE APPLICATION 70490 LODGED
Granted this first day of May 2013.

A handwritten signature in black ink, appearing to be "D. J. ...", written over a horizontal line.

Mining Registrar

CONDITIONS

The holder of the within Prospecting Permit is required to:-

- (a) use, if practicable, only existing roads or tracks on the land to which the permit applies;
- (b) take reasonable steps to ensure no reproductive material of a declared plant is moved onto, within or from the land to which the permit applies. "Declared plant" means a plant that is a declared pest under the *Land Protection (Pest and Stock Route Management) Act 2002* or declared to be a pest under a local law of a local government.
- (c) not allow an animal in the custody of the holder or person to be on the land to which the permit applies unless the land is fenced in a way to prevent the animal from leaving the land or the animal is restrained;
- (d) gain access to occupied land only at a point or points designated by a mining registrar unless the holder has obtained the consent in writing of the owner and has lodged that consent with the mining registrar;
- (e) not discharge a firearm unless the holder has the written consent of the owner of the land and the consent has been lodged with the mining registrar;
- (f) not light an open fire unless the holder has the written consent of the owner of the land and the consent has been lodged with the mining registrar;
- (g) not engage in any form of dredging;
- (h) not enter and be upon the surface of land of an owner within 100 metres laterally of a permanent building used mainly as accommodation, or for business purposes, or for community, sporting or recreational purposes, or as a place of worship, or within 50 metres laterally of a principal stockyard or dam, bore or artesian well or a cemetery or burial place without the written consent of the owner of that land lodged with the mining registrar;
- (i) not enter land within 50m laterally of a place where activities are being carried on under an exploration permit only with the written consent of the exploration permit holder;
- (j) Prior notice of entry to be served. At least 5 business days (or such shorter period as is acceptable to the owner of the land and endorsed on the Notice of Entry) before initial entry is made on land under the authority of a prospecting permit, the holder of the prospecting permit shall notify the owner of intention to enter.
- (k) A holder of a prospecting permit for land may enter the land for-
 - a. purposes necessary to enable the holder to apply for a mining claim or mining lease over the land

The holder may-

- (a) enter and leave the land using a reasonable type of transport; and
- (b) enter and leave the land through land the permit states is access land.

(l) Consent required to enter certain land

1. A parcel prospecting permit holder may enter the surface of a reserve for prospecting purposes only with the written consent of the owner of the reserve.
2. A district prospecting permit holder may enter the surface of occupied land only with the written consent of the owner of the land.
3. Also, a prospecting permit holder may enter occupied land for hand mining only with the written consent of the owner of the land.
4. In addition, a prospecting permit holder may enter restricted land only with the written consent of the owner of the land where the relevant permanent building, or relevant feature, is situated.

Note: Restricted land is defined as follows:

- a) Land within 100 m laterally of a permanent building used –
 - i. mainly as accommodation or for business purposes; or
 - ii. for community, sporting or recreational purposes or as a place of worship.
- b) Land within 50 m laterally of any of the following features –
 - i. a principal stockyard;
 - ii. a bore or artesian well;
 - iii. a dam;
 - iv. another artificial water storage connected to a water supply;
 - v. a cemetery or burial place.

5. Further, a prospecting permit holder may enter land within 50 metres laterally of a place where activities are being carried on under an exploration permit only with the written consent of the exploration permit holder.

- (m) not enter occupied land at night without the written consent of the land owner (you must comply with the owners conditions) OR unless the mining registrar permits entry at night (you must abide by the mining registrars conditions)
- (n) comply with the Code of Environmental Compliance for prospecting permits for purposes of hand mining.

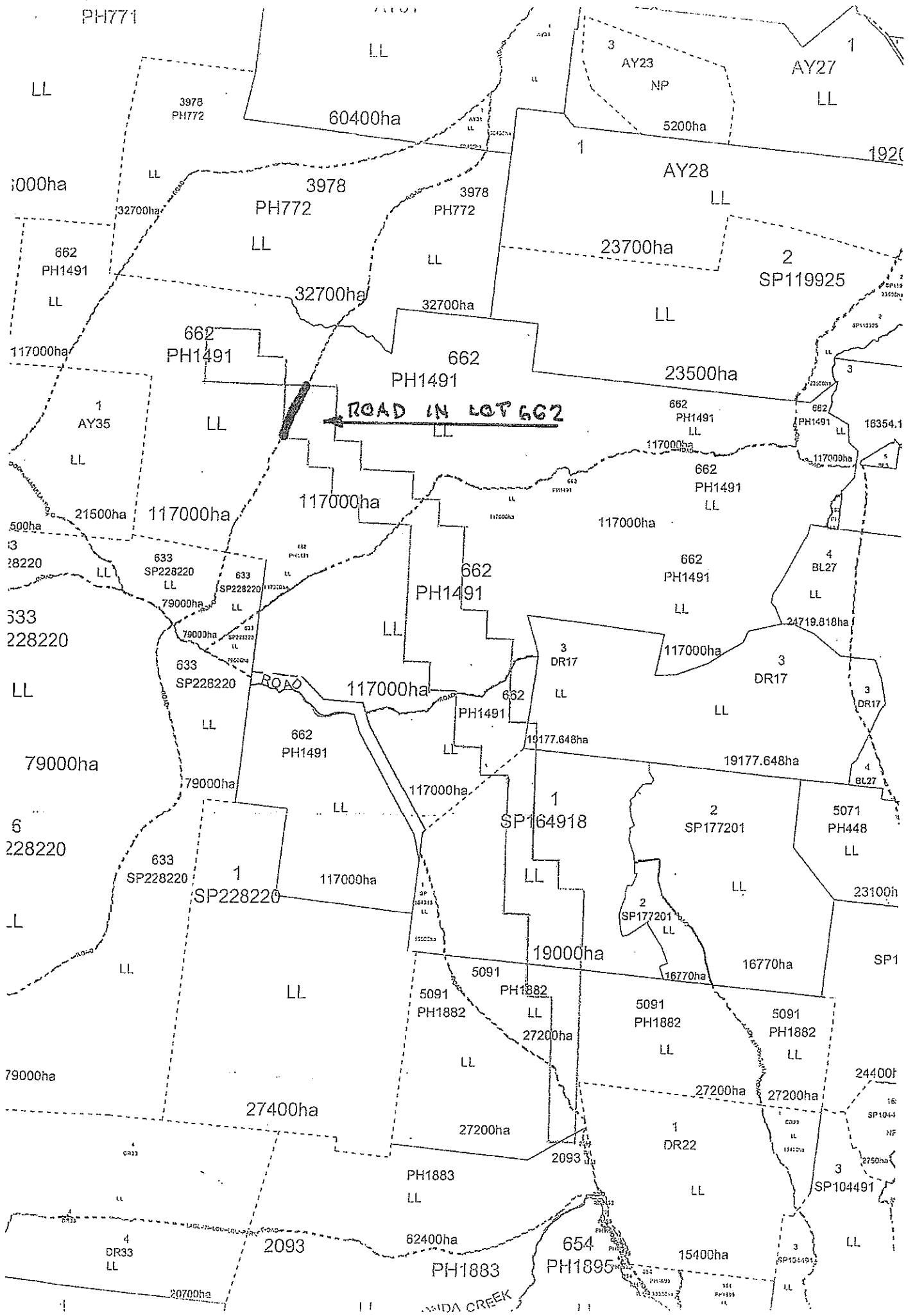

PH771

LL

AY23

AY27

LL

3978
PH772

60400ha

5200ha

1920

1000ha

32700ha

PH772

3978

3978
PH772

AY28

LL

23700ha

2
SP119925

662
PH1491

LL

32700ha

LL

32700ha

LL

117000ha

662
PH1491

LL

662
PH1491

23500ha

18354.1

ROAD IN LOT 662

662
PH1491

662
PH1491

117000ha

1
AY35

LL

117000ha

117000ha

662
PH1491

117000ha

662
PH1491

4
BL27

500ha

21500ha

LL

633
SP228220

633
SP228220

633
SP228220

3

28220

333

228220

LL

79000ha

79000ha

117000ha

662
PH1491

662
PH1491

LL

3
DR17

4
BL27

24719.818ha

LL

117000ha

662
PH1491

19177.648ha

19177.648ha

3
DR17

6

228220

LL

633
SP228220

1
SP228220

117000ha

1
SP164918

2
SP177201

5071
PH448

23100h

79000ha

LL

LL

117000ha

117000ha

19000ha

16770ha

16770ha

SP1

5091
PH1882

5091
PH1882

5091
PH1882

5091
PH1882

LL

27200ha

LL

LL

27400ha

27200ha

27200ha

27200ha

24400h

4
DR33

2093

PH1883

LL

62400ha

PH1883

654
PH1895

1
DR22

LL

15400ha

3
SP104491

LL

WANDA CREEK

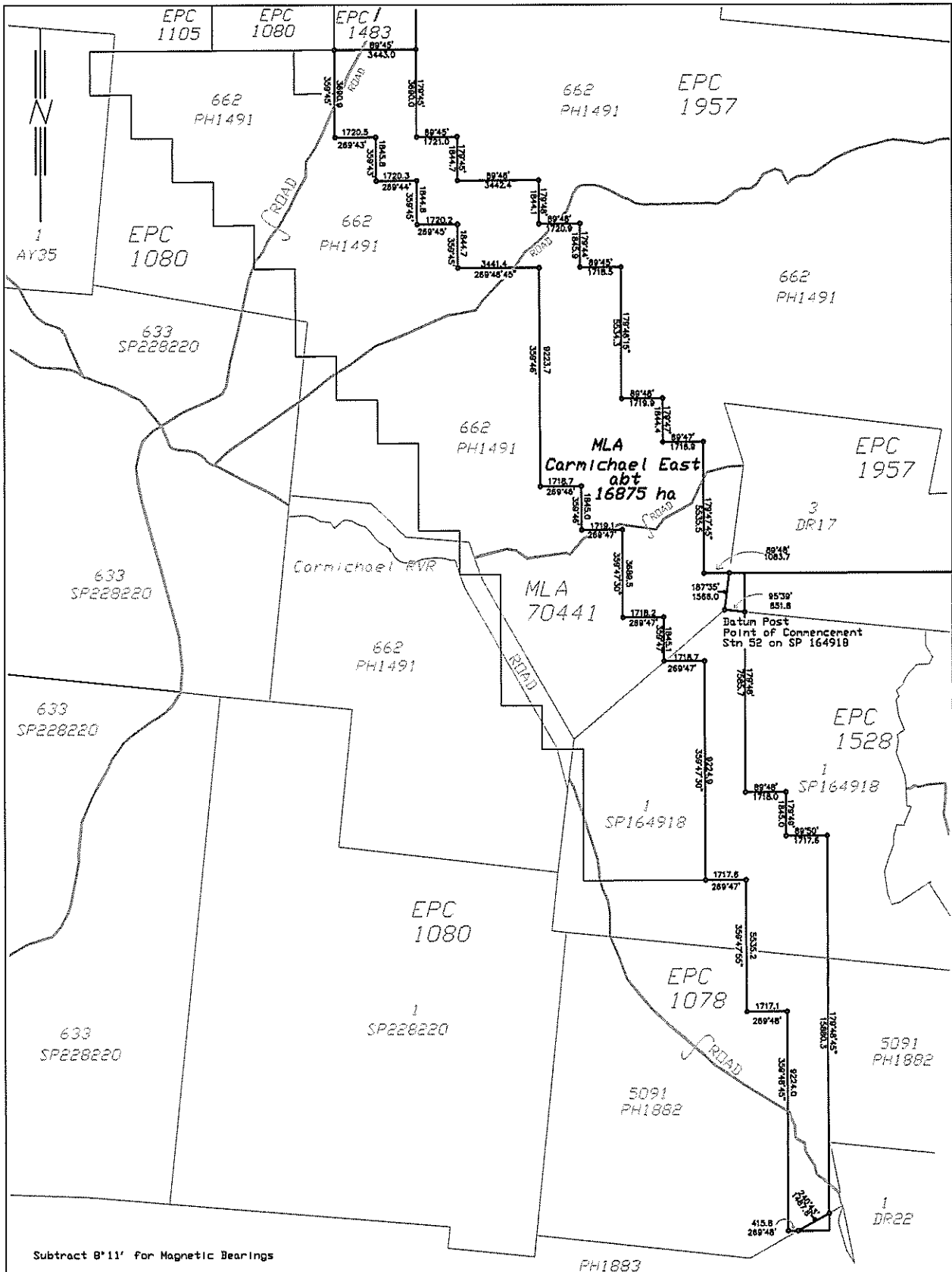

Wilson Survey Group (Qld) P/L
 PO BOX 2222 EMERALD
 Telephone 4982 2729
 Facsimile 4982 1015
 Mobile 0409 988 739
 emerald@wilsonsury.com.au
 www.wilsonsury.com.au

Plan of
Mining Lease Application
'CARMICHAEL EAST'

CLIENT:
 Adani Mining Pty Ltd

LOCAL AUTHORITY: Isaac Regional	SURVEYED: RW	DATE: / /	DRAWING NO.
PARISH: VARIOUS	COUNTY: Drury	MERIDIAN: MGA 94	Adani Carmichael East
	DRAWN: RW	SCALE: 1:50000	

Our Ref: PP 74057
Contact: Ariana Corkill
Telephone: (07) 4987 9370
Facsimile: (07) 4987 9333
Email: mines.emerald@dnrm.qld.gov.au



Department of
Natural Resources and Mines

29 May 2013

Adani Mining Pty Ltd
C/- Mining Tenement Services
GPO Box 215
BRISBANE QLD 4001

Dear Sir/Madam,

PROSPECTING PERMIT NO 74057

I wish to advise that your application for a prospecting permit has been granted for a period of three (3) months as outlined on the attached Permit and Conditions.

During the three (3) month period covered by the Permit, you or your authorised agent may enter upon the land for **the purposes marking out land** that may be the subject to an application for a mining claim/lease. Your entry onto the land is subject to your compliance with the attached conditions and Section 19 of the *Mineral Resources Act 1989*.

Please note that the Prospecting Permit has only been issued in respect of the parcel or parcels of land nominated in the application.

Yours faithfully



Shawn Brown
Mining Registrar
Emerald Mining District

Mining Registrar
Department of Natural Resources
and Mines
99 Hospital Road, Emerald
PO Box 245, Emerald
Queensland 4720 Australia
Telephone +61 7 4987 9373
Facsimile + 61 7 4987 9333
Email: mines.emerald@dnrm.qld.gov.au
Website www.dnrm.qld.gov.au



Part 3
Form Number 3

QUEENSLAND
MINERAL RESOURCES ACT 1989

PARCEL PROSPECTING PERMIT NO 74057

MINING DISTRICT : EMERALD

1. Full name and address of holder
ADANI MINING PTY LTD
C/- MINING TENEMENT SERVICES
GPO BOX 215
BRISBANE
QLD
4001

the holder of this Prospecting Permit and persons so authorised under the Mineral Resources Act 1989 by the issue of this Permit are permitted to enter upon the land described hereunder but restricted to the area and access specified in the attached sketch.

2. Locality APPROX 140KM NORTH WEST OF CLERMONT

3. Local Authority Isaac (R)

for the purpose of: PEGGING

4. Access through LOT 1 ON SP164918 LEASEHOLD GRAZING HOMESTEAD PERPETUAL LEASE 220168

5. Background Land LOT 1 ON SP164918 LEASEHOLD GRAZING HOMESTEAD PERPETUAL LEASE 220168

6. Minerals COAL

7. Date Grant 29-MAY-2013

8. Date Commence 30-MAY-2013

9. Date Expires 29-AUG-2013

10. Conditions *This Prospecting Permit is subject to the prescribed conditions and such other conditions as are imposed or varied from time to time by notice in writing and signed by the Mining Registrar.*

11. Special Circumstances CONDITIONS AS PRESCRIBED AND ATTACHED : CONSENT TO INCLUDE THE AREA OF MINING LEASE APPLICATION 70490 IN THE PROSPECTING PERMIT LODGED.

Granted this twenty-ninth day of May 2013.

Mining Registrar



CONDITIONS

The holder of the within Prospecting Permit is required to:-

- (a) use, if practicable, only existing roads or tracks on the land to which the permit applies;
- (b) take reasonable steps to ensure no reproductive material of a declared plant is moved onto, within or from the land to which the permit applies. "Declared plant" means a plant that is a declared pest under the *Land Protection (Pest and Stock Route Management) Act 2002* or declared to be a pest under a local law of a local government.
- (c) not allow an animal in the custody of the holder or person to be on the land to which the permit applies unless the land is fenced in a way to prevent the animal from leaving the land or the animal is restrained;
- (d) gain access to occupied land only at a point or points designated by a mining registrar unless the holder has obtained the consent in writing of the owner and has lodged that consent with the mining registrar;
- (e) not discharge a firearm unless the holder has the written consent of the owner of the land and the consent has been lodged with the mining registrar;
- (f) not light an open fire unless the holder has the written consent of the owner of the land and the consent has been lodged with the mining registrar;
- (g) not engage in any form of dredging;
- (h) not enter and be upon the surface of land of an owner within 100 metres laterally of a permanent building used mainly as accommodation, or for business purposes, or for community, sporting or recreational purposes, or as a place of worship, or within 50 metres laterally of a principal stockyard or dam, bore or artesian well or a cemetery or burial place without the written consent of the owner of that land lodged with the mining registrar;
- (i) not enter land within 50m laterally of a place where activities are being carried on under an exploration permit only with the written consent of the exploration permit holder;
- (j) Prior notice of entry to be served. At least 5 business days (or such shorter period as is acceptable to the owner of the land and endorsed on the Notice of Entry) before initial entry is made on land under the authority of a prospecting permit, the holder of the prospecting permit shall notify the owner of intention to enter.
- (k) A holder of a prospecting permit for land may enter the land for-
 - a. purposes necessary to enable the holder to apply for a mining claim or mining lease over the land

The holder may-

- (a) enter and leave the land using a reasonable type of transport; and
- (b) enter and leave the land through land the permit states is access land.

(l) Consent required to enter certain land

1. A parcel prospecting permit holder may enter the surface of a reserve for prospecting purposes only with the written consent of the owner of the reserve.
2. A district prospecting permit holder may enter the surface of occupied land only with the written consent of the owner of the land.
3. Also, a prospecting permit holder may enter occupied land for hand mining only with the written consent of the owner of the land.
4. In addition, a prospecting permit holder may enter restricted land only with the written consent of the owner of the land where the relevant permanent building, or relevant feature, is situated.

Note: Restricted land is defined as follows:

- a) Land within 100 m laterally of a permanent building used –
 - i. mainly as accommodation or for business purposes; or
 - ii. for community, sporting or recreational purposes or as a place of worship.
- b) Land within 50 m laterally of any of the following features –
 - i. a principal stockyard;
 - ii. a bore or artesian well;
 - iii. a dam;
 - iv. another artificial water storage connected to a water supply;
 - v. a cemetery or burial place.

5. Further, a prospecting permit holder may enter land within 50 metres laterally of a place where activities are being carried on under an exploration permit only with the written consent of the exploration permit holder.

(m) not enter occupied land at night without the written consent of the land owner (you must comply with the owners conditions) OR unless the mining registrar permits entry at night (you must abide by the mining registrars conditions)

(n) comply with the Code of Environmental Compliance for prospecting permits for purposes of hand mining.

Lot 1 on SP164918

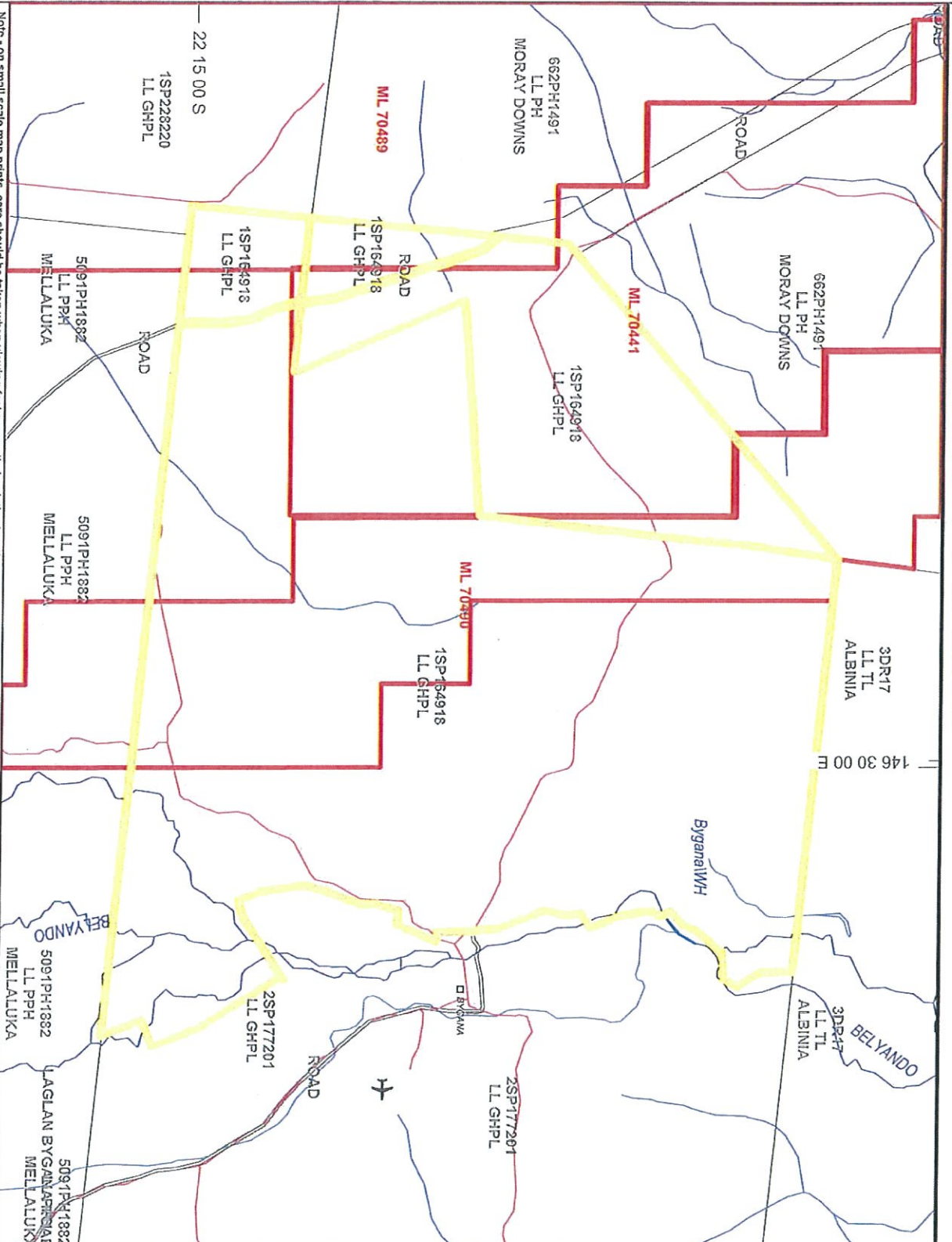

Note - on small scale map prints, care should be taken when viewing features as their relative locations may not be discernable at that scale.

Users of the information recorded in this document (the Information), accept all responsibility and risk associated with the use of the Information and should seek independent professional advice in relation to dealings with property. Despite Department of Natural Resources and Mines' (DNRM) best efforts, accuracy, reliability, completeness or timeliness in any direct, indirect and consequential costs, losses, damages and expenses incurred in any way (including but not limited to that arising from negligence) in connection with any use of or reliance on the Information.



Queensland Government
 Department of Natural Resources and Mines
 (c) 2013

Please turn over for legend

A4 From 256
 Requested By: corkilla
 Date: 5/29/13 12:46:33 PM

Projection: UTM (GDA94)
 Zone: 55
 Scale 1:113,128
 0 1 2 3 4 Km



Receipt / Tax Invoice
Department of Natural Resources and Mines

29 May 2013 01:12 pm

Page 1 of 1

GRR_200 3.0.9

(ABN: 59 020 847 551)

Receipt Number : EM314354 **Date Payment Received :** 29-MAY-2013

Received From : ADANI MINING PTY LTD
Address : C/- MINING TENEMENT SERVICES
 GPO BOX 215
 BRISBANE
 QLD
 4001

Payment Details

Pay Method: EFTPos Credit Card

Remarks :
 PP74057 APPLICATION FOR PROSPECTING PERMIT

Description	QTY	Price	GST*	Total Amount
APPLICATION FEE PROS PERMIT PARCEL PP 74057	1	\$106.60	\$0.00	\$106.60
Totals:		\$106.60	\$0.00	\$106.60

Amount Received:	\$106.60
-------------------------	-----------------

Cashier : Ariana CORKILL

Per Authorised Accounting Officer 

Cheques or other negotiable instruments accepted subject to clearance.

Contact: Emerald District Office - (07) 4987 9373

Business use only

Total Administered:	\$106.60
Total Receipt:	\$106.60

* GST is a Commonwealth Government Tax; # Refund has been authorised but has not been approved